

Code	
2200772364	03
Edition 05/2010	

INSTRUCTION AND MAINTENANCE MANUAL

COMPRESSOR UNITS

HP 10 - 15 KW 7,5 - 11

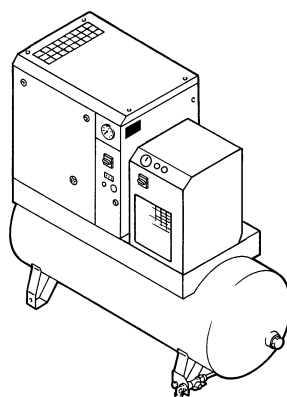

THIS MACHINE MUST BE CONNECTED TO TWO DIFFERENT POWER SUPPLIES: THREE-PHASE OR SINGLE-PHASE SUPPLY FOR THE COMPRESSOR SINGLE-PHASE SUPPLY FOR THE DRYER

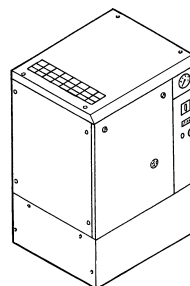
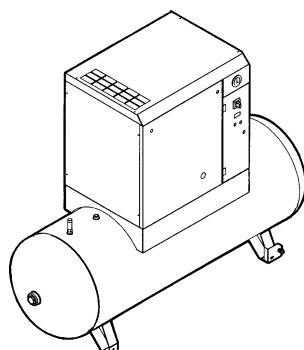

READ THIS MANUAL CAREFULLY BEFORE CARRYING OUT ANY OPERATIONS ON THE COMPRESSOR UNIT.



THIS MACHINE IS DESIGNED FOR BOTH CONTINUOUS AND INTERMITTENT OPERATION. HOWEVER, TO AVOID CONDENSATION PROBLEMS IN THE OIL, THE MACHINE MUST OPERATE WITH AT LEAST 10% OF ITS TOTAL CAPACITY. CHECK FOR SIGNS OF CONDENSATION IN THE OIL BY FOLLOWING THE INSTRUCTIONS GIVEN IN SECTION 15.2

CONTENTS

PART A: INFORMATION FOR THE USER

- 1.0 GENERAL CHARACTERISTICS
- 2.0 INTENDED USE
- 3.0 OPERATION
- 4.0 GENERAL SAFETY STANDARDS
- 5.0 DESCRIPTION OF WARNING LABELS
- 6.0 DANGER ZONES
- 7.0 SAFETY DEVICES
- 8.0 POSITION OF WARNING LABELS
- 9.0 COMPRESSOR ROOM
- 10.0 TRANSPORT AND HANDLING
- 11.0 UNPACKING
- 12.0 INSTALLATION
- 13.0 DIMENSIONS AND TECHNICAL DATA
- 14.0 MACHINE ILLUSTRATION
- 15.0 ORDINARY MAINTENANCE TO BE DONE BY THE USER
- 16.0 PERIODS OF INACTIVITY
- 17.0 SCRAPPING THE UNIT
- 18.0 LIST OF SPARE PARTS FOR ROUTINE MAINTENANCE
- 19.0 TROUBLE-SHOOTING AND EMERGENCY REPAIRS

PART B: INFORMATION RESERVED FOR TECHNICALLY SKILLED PERSONNEL

- 20.0 STARTING UP
- 21.0 GENERAL ORDINARY MAINTENANCE REQUIRES TRAINED PERSONNEL
- 22.0 CHANGING THE OIL
- 23.0 CHANGING THE OIL SEPARATING FILTER
- 24.0 BELT TENSION
- 25.0 REPLACING THE BELT
- 26.0 FLOW DIAGRAM
- 27.0 DRYER CALIBRATIONS
- 28.0 VOLTAGE CONVERSION
- WIRING DIAGRAM (ON THE BACK COVER)

IMPORTANT: A COPY OF THE WIRING DIAGRAMS CAN BE FOUND INSIDE THE ELECTRIC BOARD OF THE COMPRESSOR.

SCREW COMPRESSOR UNITS

HP 10 - 15
KW 7,5 - 11

MACHINE AND MANUFACTURER IDENTIFICATION DATA

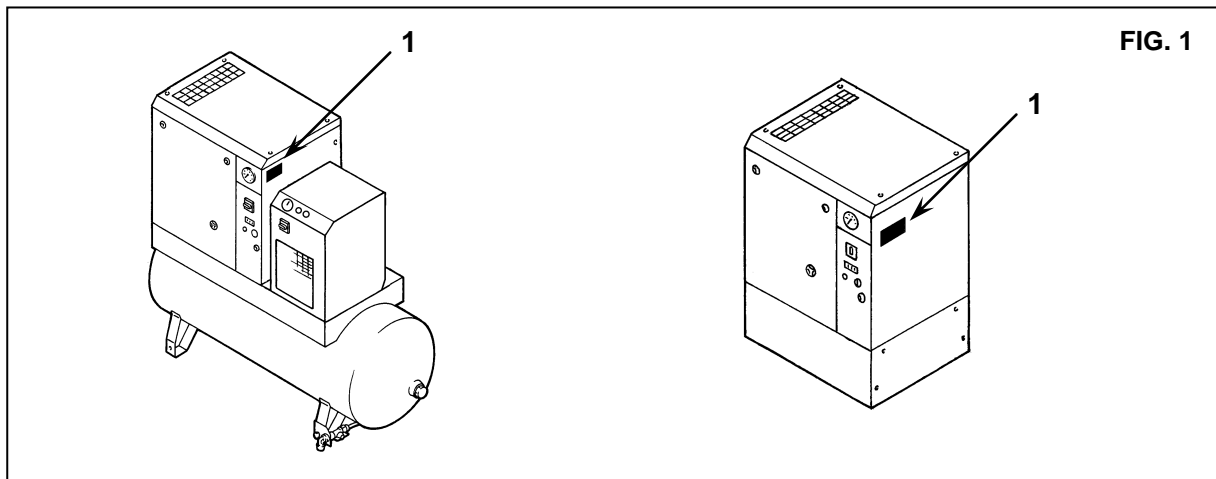

Position of the identification plate Fig. 1

FOR TECHNICAL ASSISTANCE

In the event of breakdown or malfunction of the machine, switch it off and do not tamper with it.

If repairs are needed, apply only to a technical assistance centre approved by the manufacturer and insist on the use of genuine Devair spare parts.

Failure to comply with the above may endanger the safety of the machine.

INTRODUCTION

Keep this manual with care for future consultation; the use and maintenance manual is an integral part of the machine. Read this manual carefully before carrying out any operations on the compressor unit.

The installation of the compressor unit and all operations involving it must be performed in conformity with the regulations in force concerning electric plants and personal safety.

CHARACTERISTICS AND SAFETY PRECAUTIONS



MACHINE WITH AUTOMATIC START



BEFORE REMOVING THE PROTECTIVE GUARDS TO CARRY OUT ANY MAINTENANCE ON THE MACHINE, SWITCH OFF THE ELECTRIC POWER SUPPLY AND DISCHARGE THE RESIDUAL PRESSURE INSIDE THE UNIT.

ALL ELECTRIC WORK ON THE MACHINE, HOWEVER SLIGHT, SHOULD BE CARRIED OUT BY PROFESSIONALLY TRAINED PERSONNEL.

- To prevent internal corrosion, which could compromise the safety of the compressed air tank, the condensation that is produced must be discharged at least once a day. If an automatic drain fitted to the air receiver is present, a weekly check of correct functioning of the automatic valve is needed.
- The thickness of the tank should be controlled against legislation currently in force in the country where the tank is installed.
- The tank cannot be used and must be replaced if the thickness falls below the level given in the instruction documents for the tank.
- The tank can be used within the temperature limits given in the conformity declaration.

The manufacturer does not accept responsibility for damage caused as a result of negligence or failure to abide by the instructions given above.

THIS MACHINE IS NOT SUITABLE FOR EXTERNAL INSTALLATION

THIS MACHINE CORRESPOND TO THE ESSENTIAL SAFETY REQUIREMENTS FORESEEN FROM THE EUROPEAN STANDARD (98/37 CE), AND THE RULE EN 292

1.0 GENERAL CHARACTERISTICS

The compressor units use single-stage screw rotary air compressors with oil injection.

The system is self-bearing and does not require bolts or other devices to anchor it to the floor.

The unit is completely assembled in the factory; the necessary connections for setting it up are:

- connection to the power mains (see installation chapter)
- connection to the compressed air network (see installation chapter)

2.0 INTENDED USE

The compressor has been built to supply compressed air for industrial use.

The machine cannot be used in premises where there is a risk of fire or explosion or where work is carried out which releases substances into the environment which are dangerous with regard to safety (for example: solvents, flammable vapours, alcohol, etc.). In particular the compressor cannot be used to produce air to be breathed by humans or used on direct contact with foodstuffs. These uses are allowed if the compressed air produced is filtered by means of a suitable filtering system (Consult the manufacturer for these special uses.)

This compressor must be used only for the purpose for which it was specifically designed.

All other uses are to be considered incorrect and therefore unreasonable.

The Manufacturer cannot be held responsible for any damage resulting from improper, incorrect or unreasonable use.

The lubricating liquids and other eventual fluids must not be discharged in the environment. These polluting and hazardous products must compulsorily be disposed by charging authorised and specialised firms according to the different typology of product. Differentiate the compressor components according to the different construction materials (plastic, copper, iron, oil filter, air filter ecc...)

3.0 OPERATION

3.1 OPERATION FOR COMPRESSOR

The electric motor and the compressor unit are coupled by means of a belt transmission.

The compressor unit takes in the outside air through the suction valve. The intake air is filtered by the filter cartridge fitted upstream from the intake valve. Inside the compressor unit, the air and the lubricating oil are compressed and sent to the oil separating tank where the oil is separated from the compressed air; the air is then filtered again by the oil separating cartridge to reduce the amount of suspended oil particles to a minimum. The machine is fitted with a suitable air-cooling system.

The machine is protected by a special safety thermostat: if the oil temperature reaches $105 \div 110 \text{ }^{\circ}\text{C}$ ($221 \div 230 \text{ }^{\circ}\text{F}$) the machine cuts out automatically.

3.2 OPERATION FOR DRYER

Air flows from the tank to the drier and is then dried and sent to the distribution network. Dryer operation is described below.

The gaseous refrigerant coming from the evaporator (4) is sucked by the refrigeration compressor (1) and it is pumped into the condenser (2). This allows its condensation, eventually with the help of the fan (3); the condensed refrigerant passes through the dewatering filter (8) and it expands through the capillary tube (7) and goes back to the evaporator where it produces the refrigerating effect.

Due to the heat exchange with the compressed air which passes through the evaporator against the stream, the refrigerant evaporates and goes back to the compressor for a new cycle.

The circuit is equipped with a bypass system for the refrigerant; this intervenes to adjust the available refrigerating capacity to the actual cooling load.

This is achieved by injecting hot gas under the control of the valve (9): this valve keeps constant the pressure of the refrigerant in the evaporator and therefore also the dew point never decreases below $0 \text{ }^{\circ}\text{C}$ ($32 \text{ }^{\circ}\text{F}$) in order to prevent the condensate from freezing inside the evaporator.

The drier runs completely automatically; it is calibrated in the factory for a dew point of $\sim 3 \text{ }^{\circ}\text{C}$ ($37,4 \text{ }^{\circ}\text{F}$) and therefore no further calibrations are required.

DRYER FLOW DIAGRAM

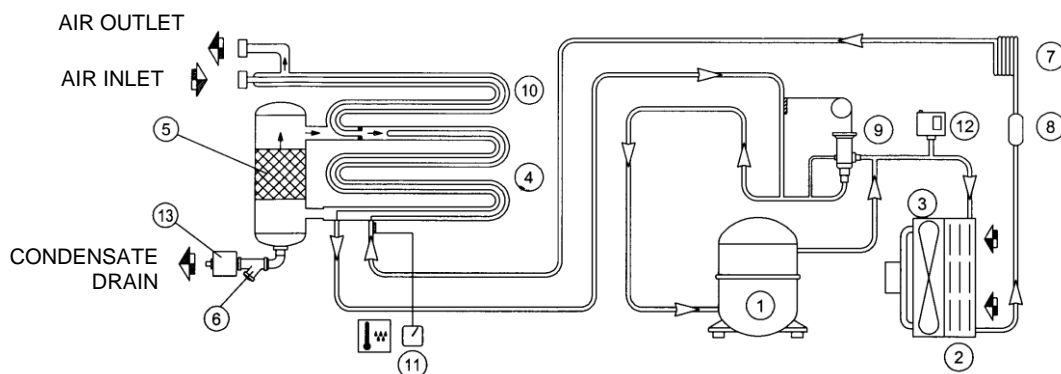

4.0 GENERAL SAFETY STANDARDS

The compressor may be used only by specially trained and authorized personnel.

Any tampering with the machine or alterations not approved beforehand by the Manufacturer relieve the latter of responsibility for any damage resulting from the above actions.











The removal of or tampering with the safety devices constitutes a violation of the European Standards on safety.

ATTENTION: UPSTREAM OF THE MACHINE INSTALL AN ISOLATOR KNIFE-SWITCH WITH AN AUTOMATIC CUTOUT AGAINST CURRENT SURGES AND EQUIPPED WITH A DIFFERENTIAL DEVICE FOR CALIBRATIONS SEE WIRING DIAGRAM ON LAST PAGE



ALL ELECTRIC WORK ON THE MACHINE, HOWEVE SLIGHT, SHOULD BE CARRIED OUT BY PROFESSIONALLY TRAINED PERSONNEL.

5.0 DESCRIPTION OF WARNING LABELS

	1) FLUID EJECTION		6) HIGH PRESSURE
	2) DANGEROUS ELECTRIC VOLTAGE		7) HOT PARTS
	3) AIR NOT FIT FOR BREATHING		8) MOVING PARTS
	4) NOISE		9) FAN ROTATING
	5) MACHINE WITH AUTOMATIC START		10) PURGE EVERY DAY

5.1 DESCRIPTION OF COMPULSORY SIGNALS

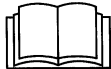
	11) READ THE USE AND MAINTENANCE INSTRUCTIONS		
---	---	--	--

6.0 DANGERS ZONES

6.1 DANGERS ZONES FOR COMPRESSOR UNIT

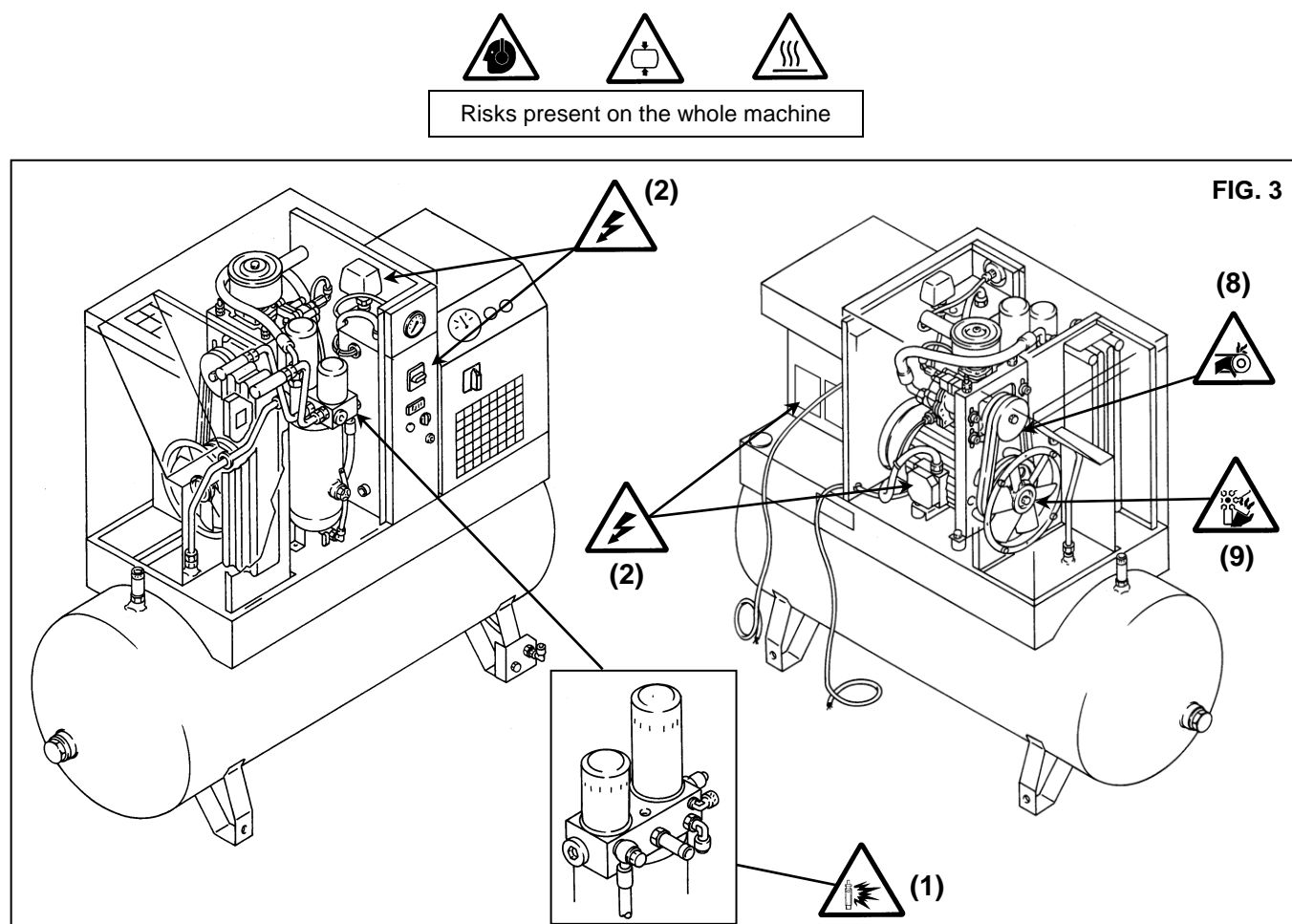

6.2 DANGERS ZONES FOR DRYER UNIT AND TANK



Risks present on the whole machine

FIG. 3A

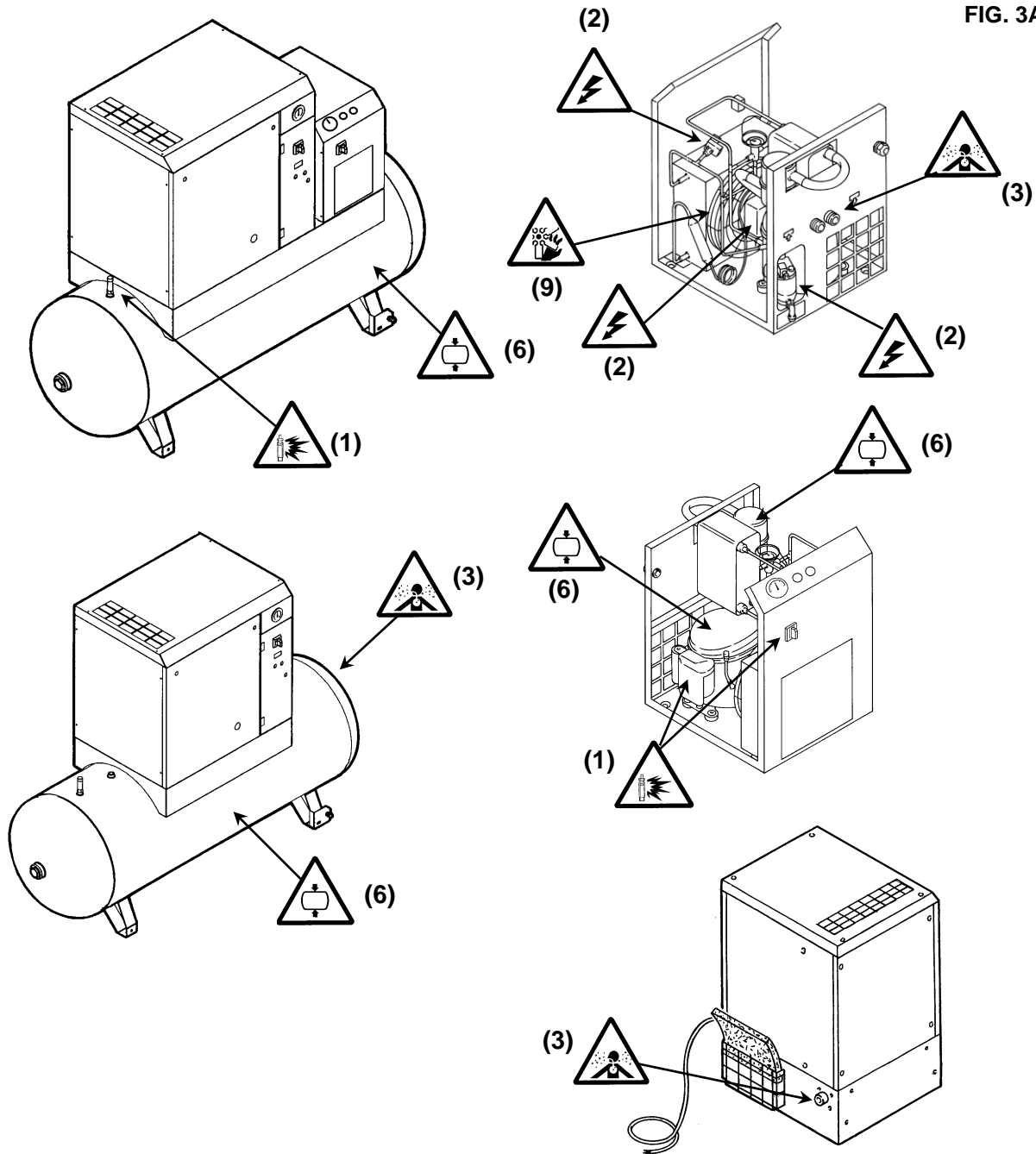

7.0 SAFETY DEVICES

7.1 SAFETY DEVICES FOR SCREW COMPRESSOR (Fig. 4)

- 1) Safety screws
- 2) The front protection can be opened with a special key
- 3) Fixed protection device - cooling fan / pulley
- 4) Safety valve
- 5) Emergency stop
- 6) Oil filling cover (with safety breather)

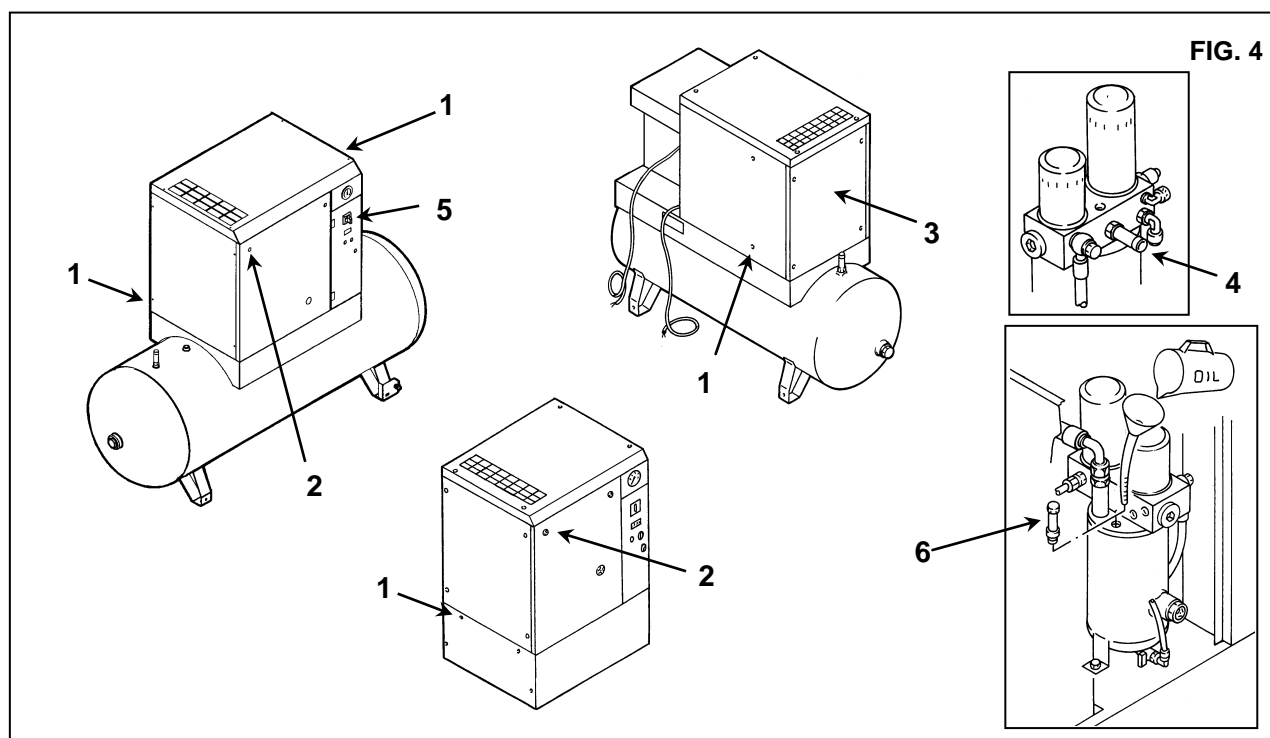

FIG. 4

7.2 SAFETY DEVICES FOR DRYER UNIT AND TANK

- 1) Safety valve
- 2) Protective switch cover
- 3) Protective pressure switch cover
- 4) Relay for refrigerant compressor (automatic)
- 5) Overload protector for refrigerant compressor

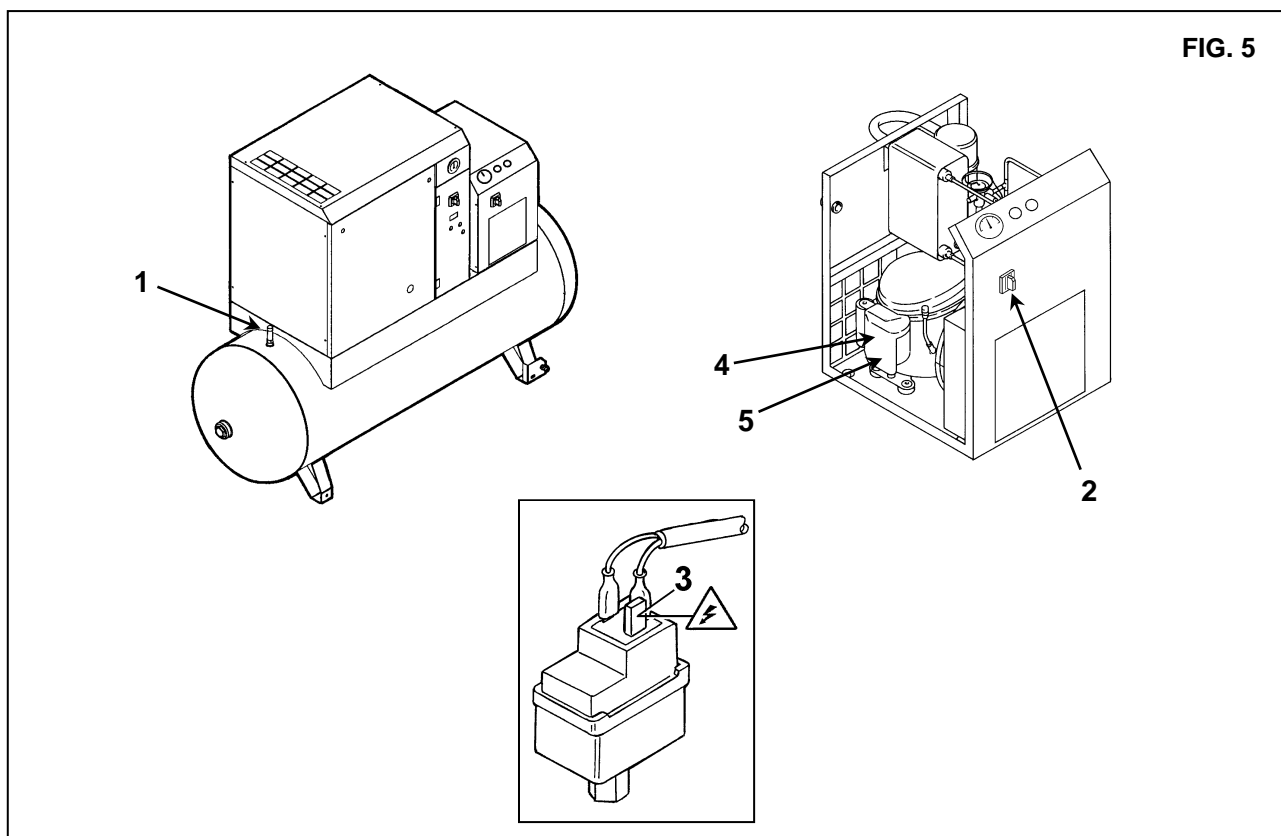

FIG. 5

8.0 POSITION OF WARNING LABELS

8.1 POSITION OF THE WARNING LABELS FOR COMPRESSOR UNIT

The plates fitted on the compressor unit are part of the machine; they have been applied for safety purposes and must not be removed or spoiled for any reason.

- 1) Dangers plate Code 2202260791
- 2) Plate "Machine with automatic start" Code 2202260791
- 3) Electrical label
- 4) Electrical label Code 2202722100
- 5) Electrical label

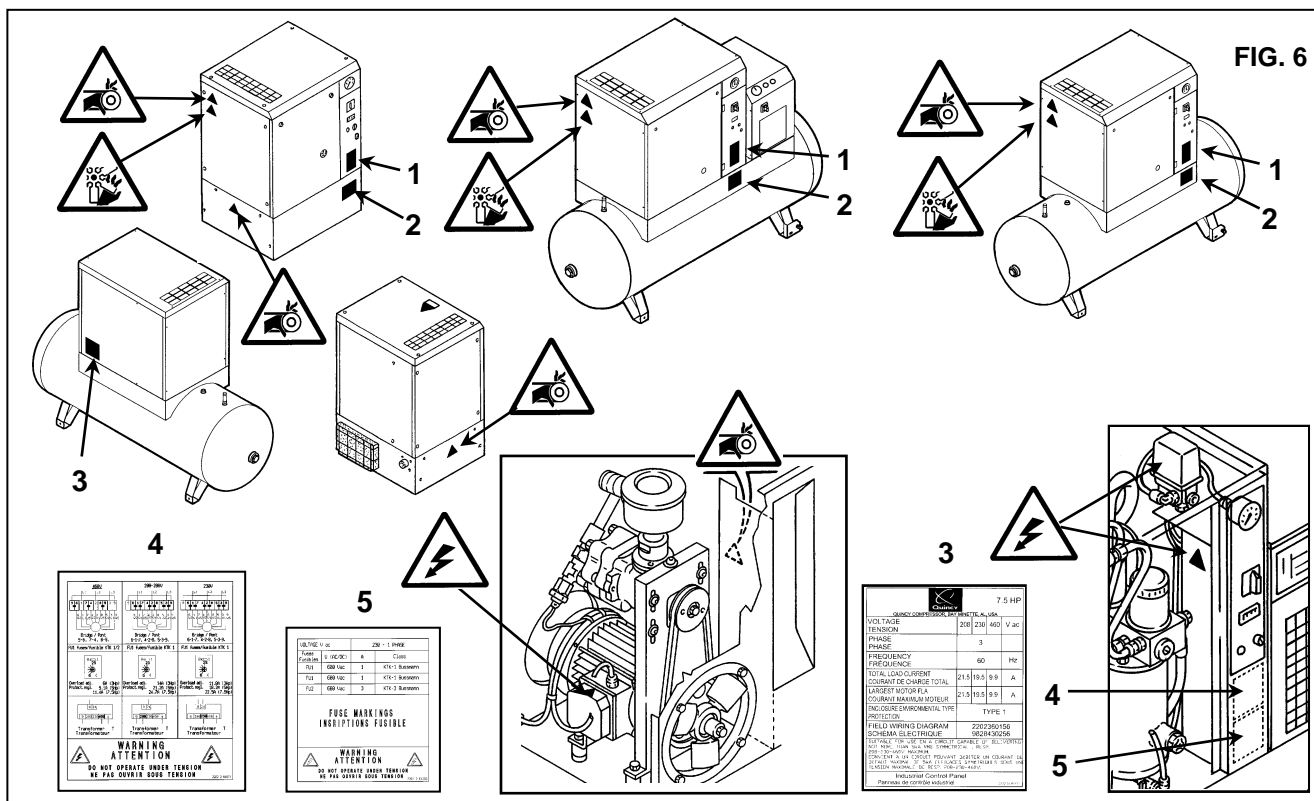

8.2 POSITION OF WARNING LABELS FOR DRYER UNIT AND TANK

The warning labels on the dryer unit are part of the machine; they have been applied for safety purposes and must not be removed or damaged for any reason.

- 1) Dangers plate Code 1079992655
- 2) Electrical label
- 3) Electrical label Code 2202261001

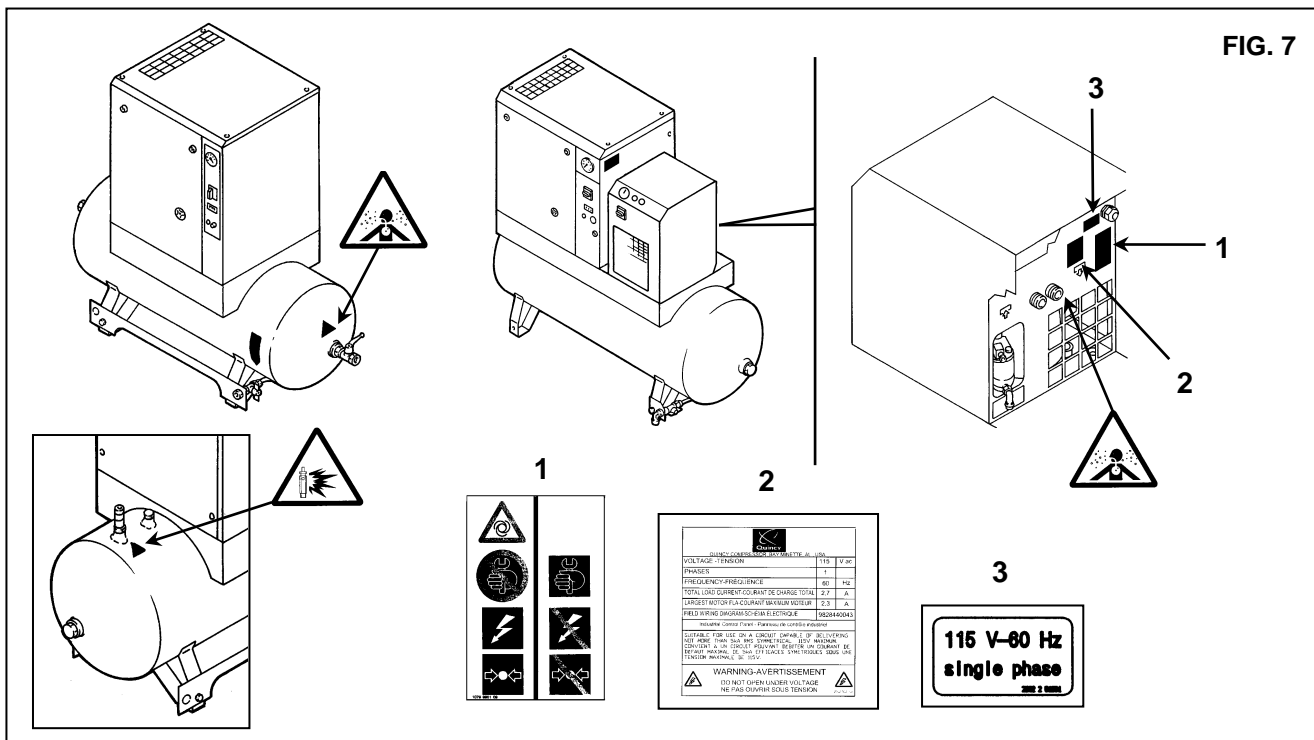

8.3 POSITION OF THE DATA PLATE FOR COMPRESSOR UNIT

FIG. 8

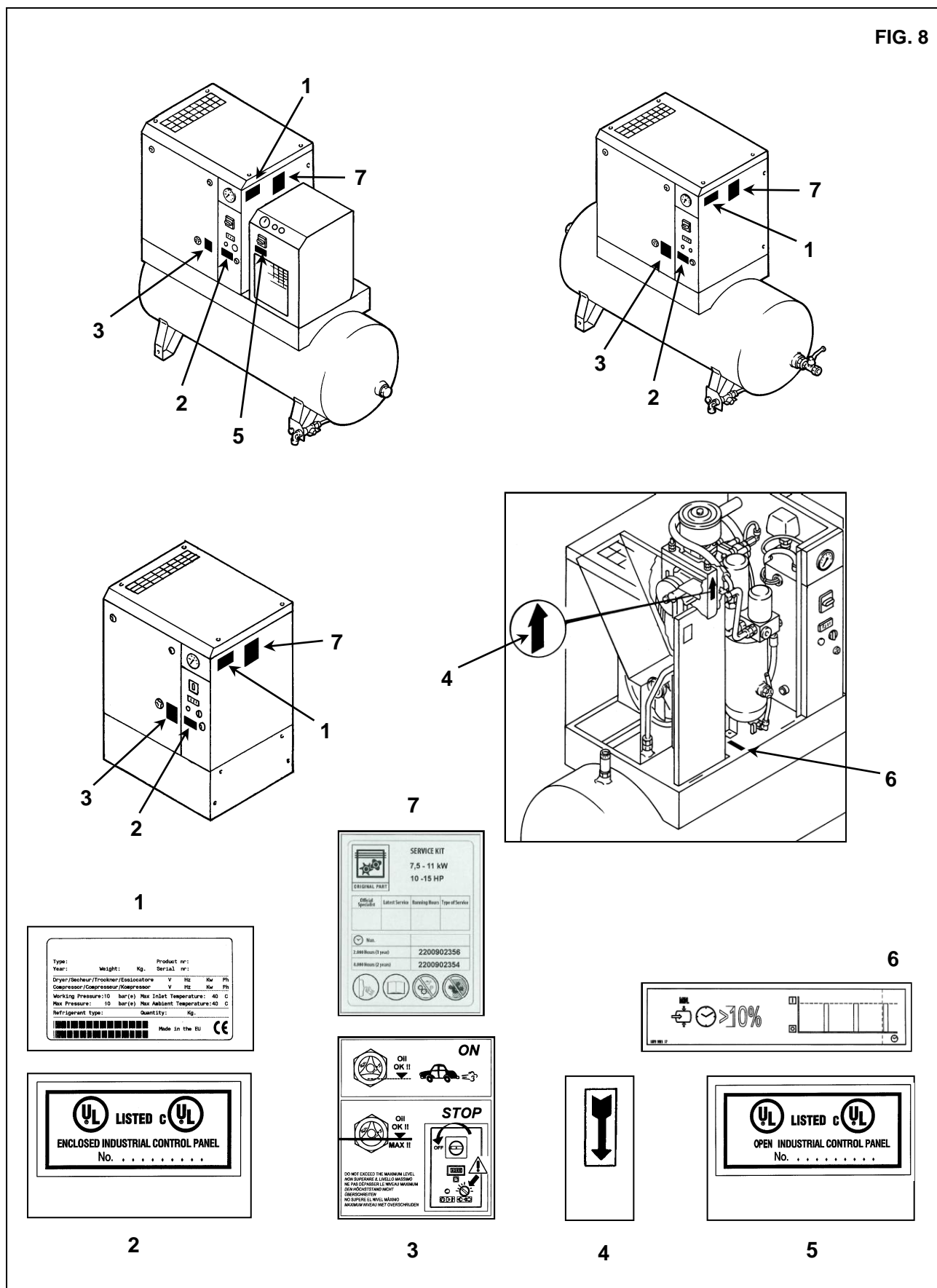

8.4 POSITION OF THE DATA PLATE FOR DRYER – AIR RECEIVER

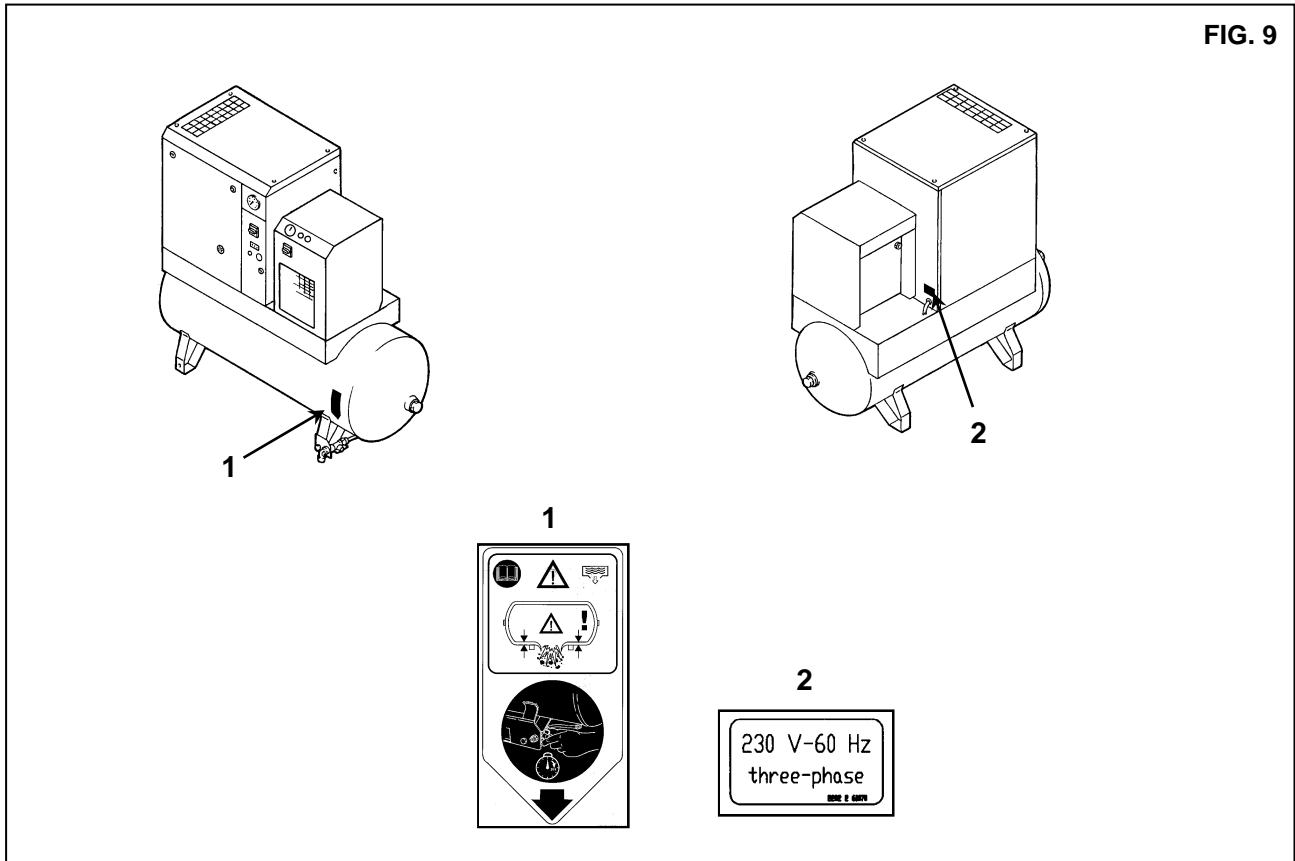

9.0 COMPRESSOR ROOM

9.1 FLOOR

The floor must be even and of industrial type; the total weight of the machine is shown in the Chap. 13.0 Remember the total weight of the machine when positioning it.

9.2 VENTILATION

When the machine is operating, the room temperature must not be higher than **40 °C (104 °F)** or lower than **5 °C (41 °F)**.

The volume of the room must be about **30 m³**

The room must be provided with 2 openings for ventilation with a surface area of about **0,5 m²** each.

The first opening must be in a high position to evacuate the hot air, the second opening must be low to allow the intake of external air for ventilation.

If the environment is dusty it is advisable to fit a filtering panel on this opening.

9.3 EXAMPLES OF VENTILATION OF THE COMPRESSOR ROOM

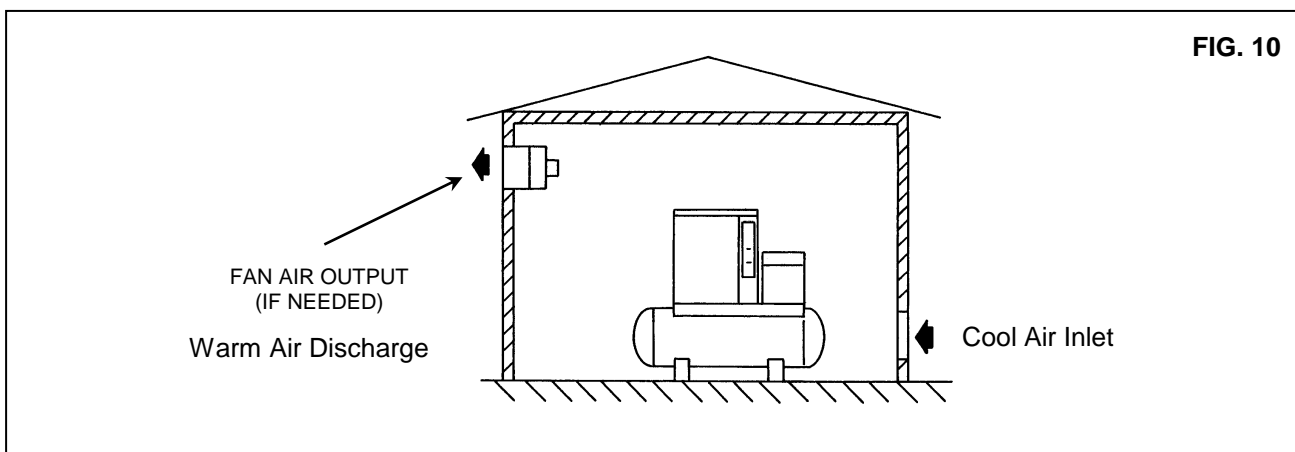

10.0 TRANSPORT AND HANDLING

The machine must be transported as shown in the following figures.

FIG. 11

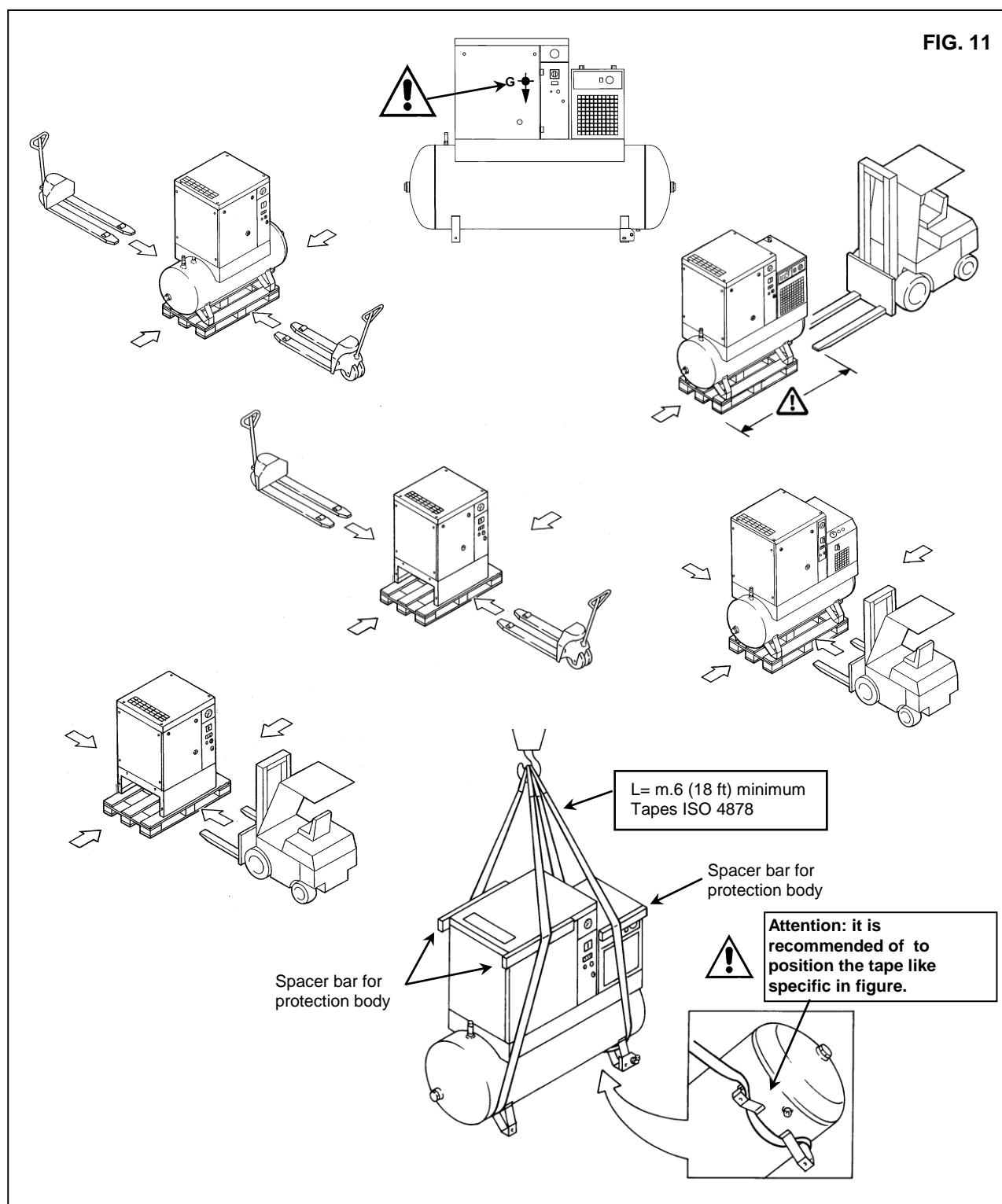

11.0 UNPACKING

After removing the packing, ensure that the machine is unbroken and that there are no visibly damaged parts. If you are in doubt, do not use the machine but apply to the manufacturer technical assistance service or to your dealer. The packing material (plastic bags, polystyrene foam, nails, screws, wood, metal strapping, etc..) must not be left within the reach of children or abandoned in the environment, as they are a potential source of danger and pollution. Dispose of these materials in the approved collection centres.

12.0 INSTALLATION

12.1 POSITIONING

After unpacking the equipment and preparing the compressor room, put the machine into position, checking the following items:

- Ensure that there is sufficient space around the machine to allow maintenance (see Fig. 12).
- Check that the compressor is standing on a perfectly flat floor.

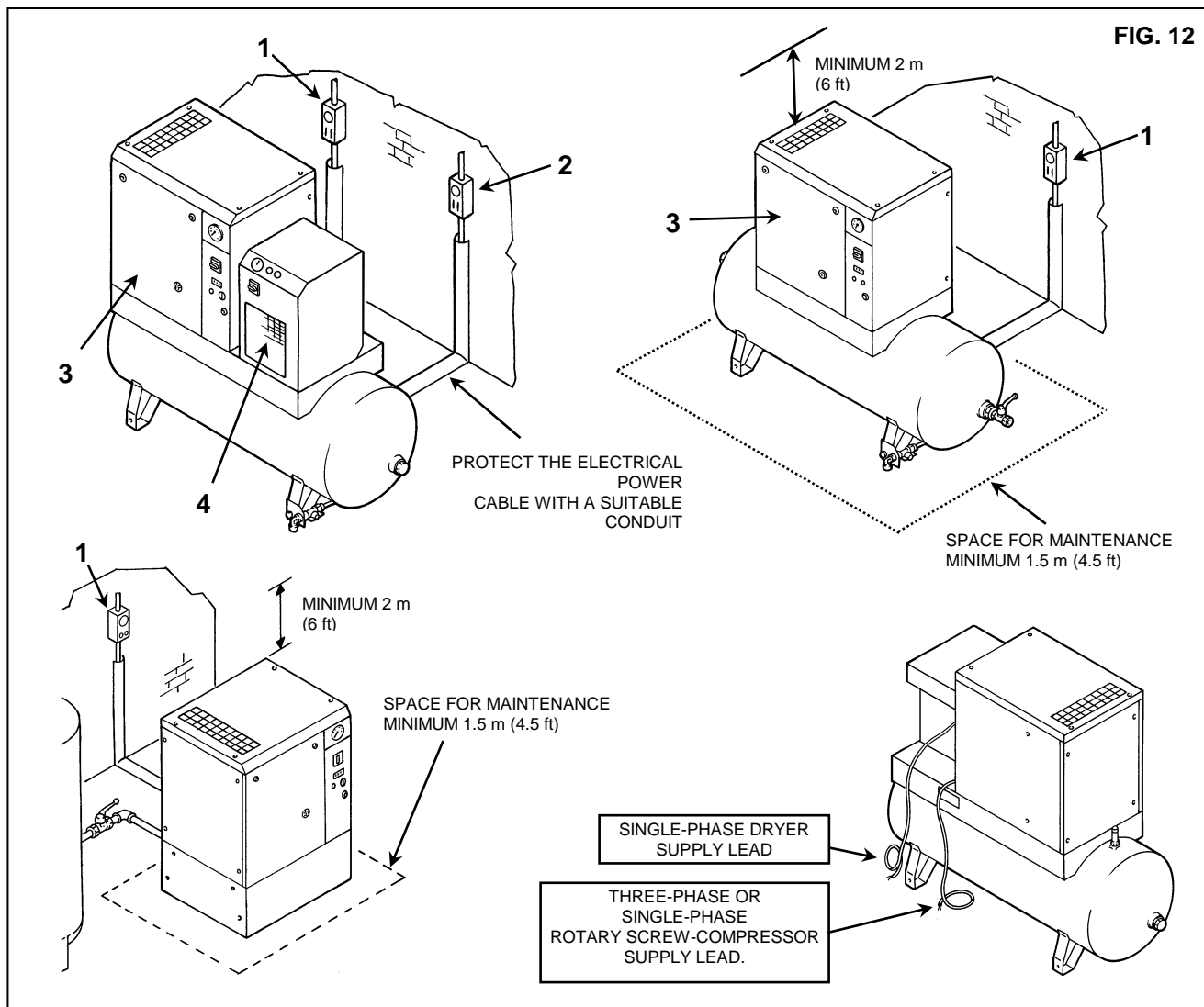

ENSURE THAT THE OPERATOR CAN SEE THE WHOLE MACHINE FROM THE CONTROL PANEL AND CHECK THE PRESENCE OF ANY UNAUTHORIZED PERSONS IN THE VICINITY OF THE MACHINE.

12.2 ELECTRICAL CONNECTION

- Check that the supply voltage is the same as the value indicated on the machine data plate.
CAUTION: the compressor Ref. 3 and the dryer Ref. 4 have two separate feeds, respectively three-phase or single-phase and single-phase.
- Check the condition of the line leads and ensure that there is an efficient earth lead.
- Ensure that there is an automatic cut-out device upstream for the machine against overcurrents, with a differential device (see Ref. 1 for compresseur Ref. 2 for dryer) wiring diagram.
- Connect the machine power cables with the greatest care, according to the standards in force.
These cables must be as indicated on the machine wiring diagram.



ONLY PROFESSIONALLY TRAINED PERSONNEL MAY HAVE ACCESS TO THE ELECTRIC PANEL. SWITCH OFF THE POWER BEFORE OPENING THE DOOR OF THE ELECTRIC PANEL.

COMPLIANCE WITH THE REGULATIONS IN FORCE CONCERNING ELECTRIC PLANTS IS FUNDAMENTAL FOR OPERATOR SAFETY AND FOR THE PROTECTION OF THE MACHINE.

CABLES, PLUGS AND ALL OTHER TYPE OF ELECTRIC MATERIAL USED FOR THE CONNECTION MUST BE SUITABLE FOR THE USE AND COMPLYING WITH THE REQUIREMENTS STATED BY THE REGULATIONS IN FORCE.

12.3 CONNECTION TO THE COMPRESSED AIR NETWORK

Fit a manual interception valve Ref. 1 between the machine and the compressed air network so that the compressor may be isolated during maintenance operations; (see figure 13) .

PIPES, FITTINGS AND CONNECTIONS USED FOR THE CONNECTION OF THE COMPRESSOR TO THE COMPRESSED AIR NETWORK MUST BE SUITABLE TO THE USE ACCORDING TO THE PRESCRIPTIONS OF THE REGULATIONS IN FORCE IN THE COUNTRY OF USE.



ALL DAMAGE DUE TO THE FAILURE TO COMPLY WITH THESE INDICATIONS CANNOT BE ATTRIBUTED TO THE MANUFACTURER AND MAY CAUSE INVALIDITY OF THE GUARANTEE CONDITIONS.

FIG. 13

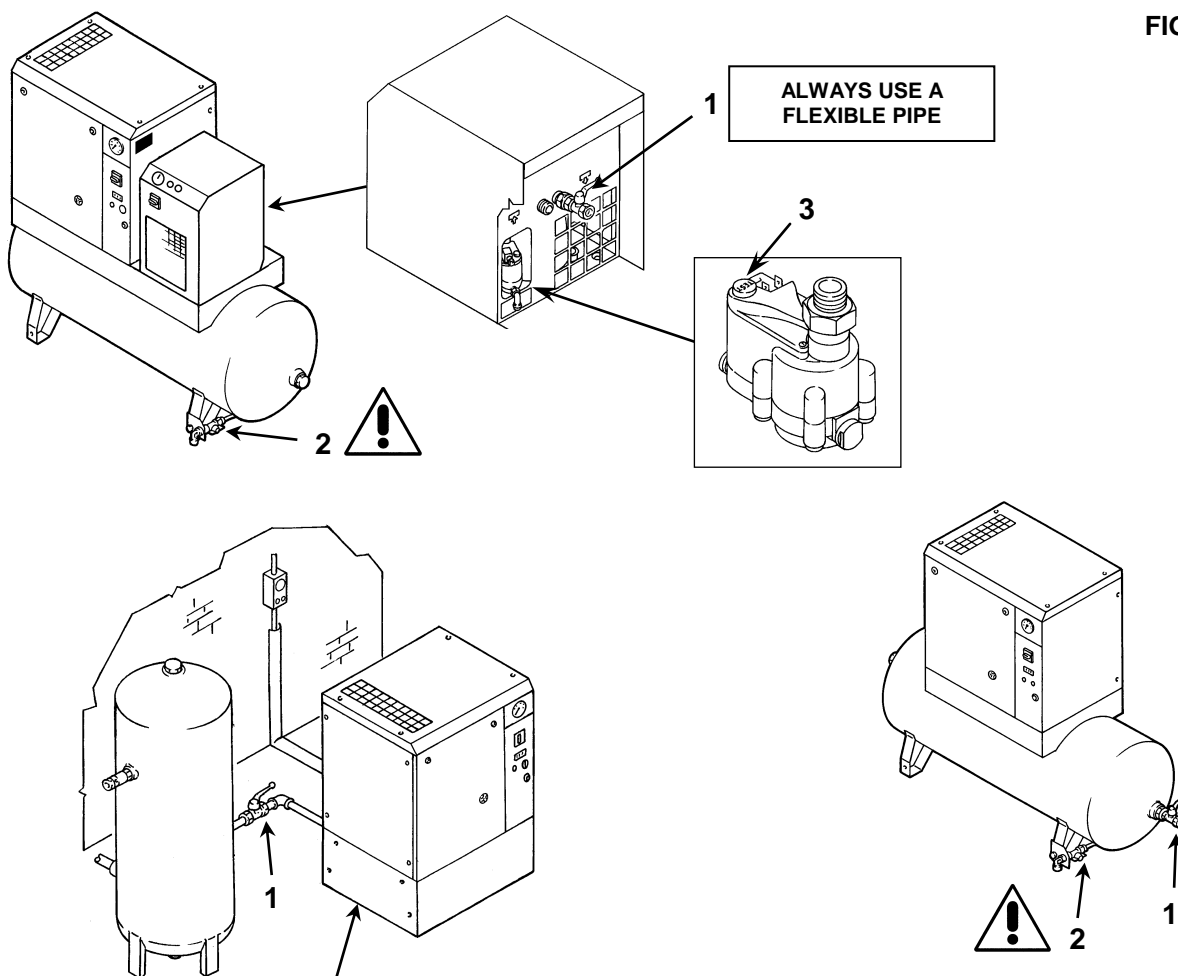

THE COMPRESSOR MUST BE CONNECTED TO A TANK COMPLETE WITH SAFETY VALVE (CAT. "IV" P.E.D. 97/23).

The manual drainage (Ref. 2 Fig. 13) the condensate automatic drain (Ref. 3 Fig. 13) are led outside the machine with a flexible pipe that may be inspected. Drainage must comply with the local regulations in force.



ALL DAMAGE DUE TO THE FAILURE TO COMPLY WITH THESE INDICATIONS CANNOT BE ATTRIBUTED TO THE MANUFACTURER AND MAY CAUSE INVALIDITY OF THE GUARANTEE CONDITIONS.

12.4 STARTING UP

See part B of this manual, **Chapter 20.0**

13.0 DIMENSIONS AND TECHNICAL DATA

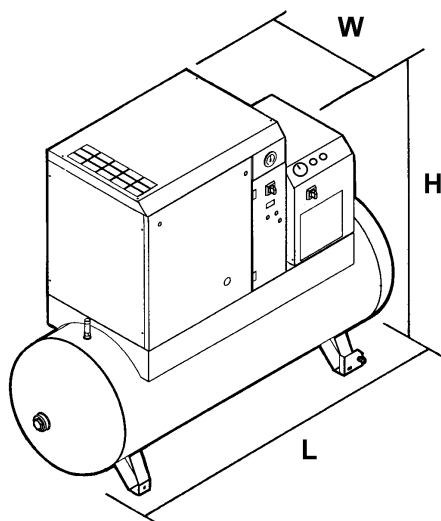

HP 10-15 KW 7,5-11	Dimensions mm (in)			Air connetion
	L	W	H	
	1875 (73,8)	620 (24,4)	1483 (58,3)	

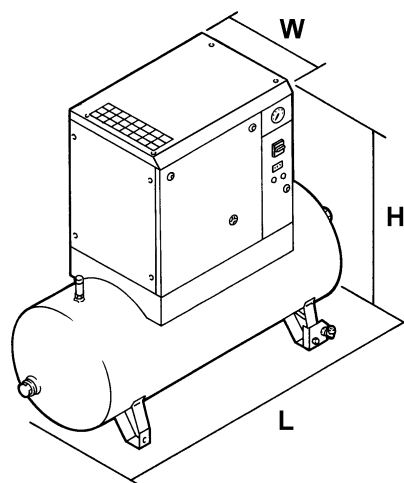

HP 10-15 KW 7,5-11	Dimensions mm (in)			Air connetion
	L	W	H	
	1875 (73,8)	620 (24,4)	1483 (58,3)	

HP 10-15 KW 7,5-11	Dimensions mm (in)			Air connetion
	L	W	H	
	810 (31,8)	650 (25,5)	995 (39,1)	

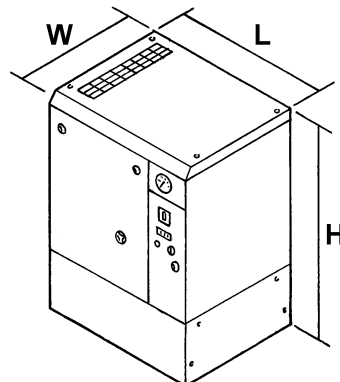

	HP 10 kW 7,5			HP 15 kW 11		
Setting pressure bar (PSI)	6,8 (100)	8,6 (125)	10 (145)	6,8 (100)	8,6 (125)	10 (145)
Standard air capacity l/min.	1123	1020	920	1610	1440	1310
Net weigt Kg. (lb) with dryer	326 (718,7)			340 (750)		
Net weigt Kg. (lb) without dryer	293 (646)			305 (672,4)		
Net weigt Kg. (lb) on base	168 (370)			180 (397)		
Setting thermostat °C (°F)	105 ÷ 110 (221 ÷ 230) permanent setting					
Oil Capacity Liters	~ 3					
Noiose product. dB(A)	66	66	66	68	66	66

TYPE DRYER	Weight Kg. (lb)	R 134a Kg. (lb)		Nominal Power W (HP)		Nominal Power W (HP)		Nominal Power W (HP)		bar MAX. 
		50 Hz	60 Hz	50 Hz	60 Hz	50 Hz	60 Hz	50 Hz	60 Hz	
A 3	25 (55,1)		0,350 (0,77)		256w (0,34)		45w (0,06)		301w (0,40)	bar 13 (psi 188,5)
A 4	27 (59,5)		0,450 (0,99)		320w (0,42)		45w (0,06)		365w (0,48)	bar 13 (psi 188,5)

Reference conditions:

Ambient temperature 25 °C (77 °F)
Inlet air temperature 35 °C (45 °F)
Pressure 7 bar (psi 101,5)
Dew point in pressure 3 °C (37,4 °F)

Limit conditions:

Max. ambient temperature 43°C (109,4 °F)
Min. ambient temperature 5°C (41 °F)
Max. inlet air temperature 55°C (131 °F)
Max. working pressure 13 bar (psi 188,5)

14.0 MACHINE ILLUSTRATION

14.1 GENERAL LAY-OUT FOR DRYER AND TANK

- 1 Refrigerant compressor
- 2 Condenser
- 3 Motor fan
- 4 Evaporator
- 5 Condensate drain
- 6 Hot gas bypass valve
- 7 Expansion capillary tube
- 8 Refrigerant filter
- 9 Condensate manual drainage

- 10 Compressed air tank
- *11 Safety valve (Compressed air tank)

*** IT IS FORBIDDEN TO TAMPER WITH THE
SETTING VALUES OF THE SAFETY VALVE**

FIG. 14

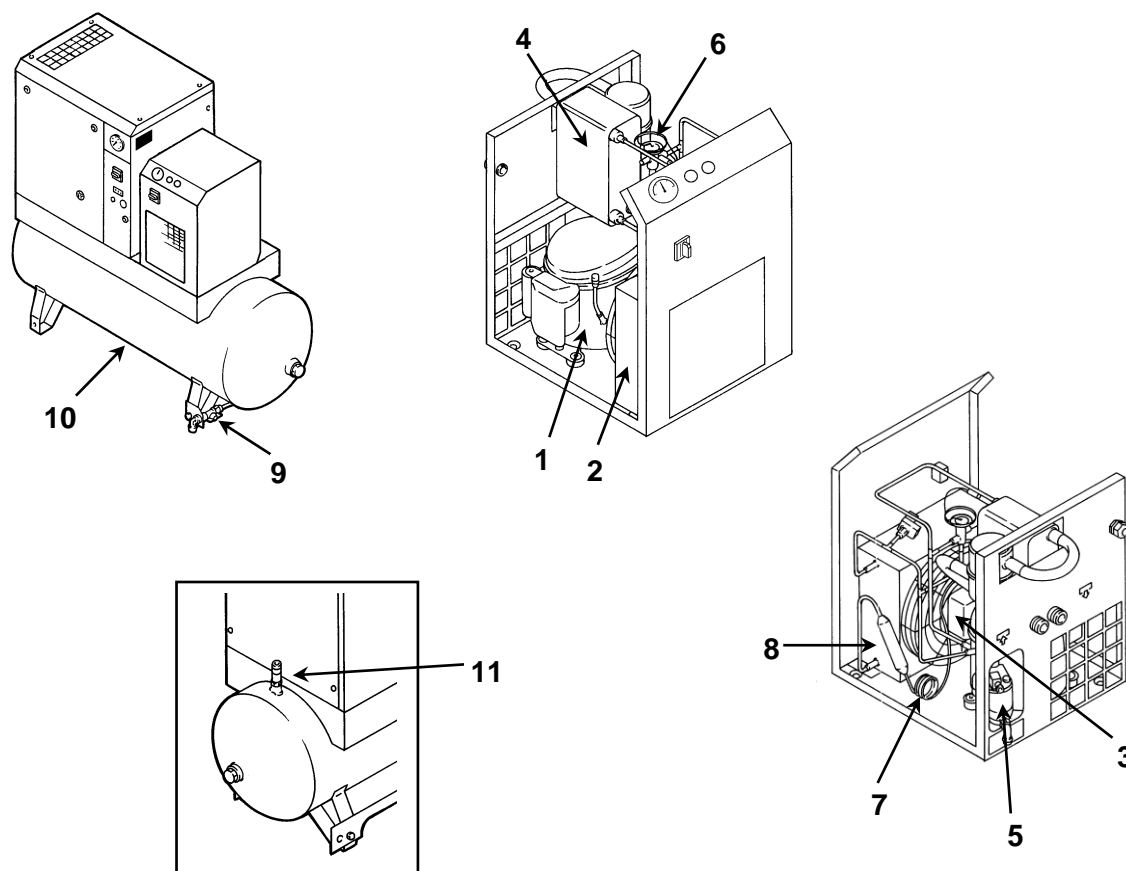

14.2 GENERAL LAY-OUT FOR SCREW COMPRESSOR

- | | |
|--|----------------------------|
| 1 Air suction filter | 12 Oil discharge |
| 2 Thermostatic valve | 13 Oil tank |
| 3 Oil filter | 14 Delivery pressure gauge |
| 4 Air-oil cooler | * 15 Safety valve |
| 5 Suction unit | 16 Electric motor |
| 6 Belt tightening system | 17 Screw compressor |
| 7 Minimum pressure valve | |
| 8 Air-oil separator with oil separating filter | |
| 9 Top-up or oil filling cap | |
| 10 Control panel | |
| 11 Oil gauge | |

*** IT IS FORBIDDEN TO TAMPER WITH THE SETTING VALUES OF THE SAFETY VALVE**

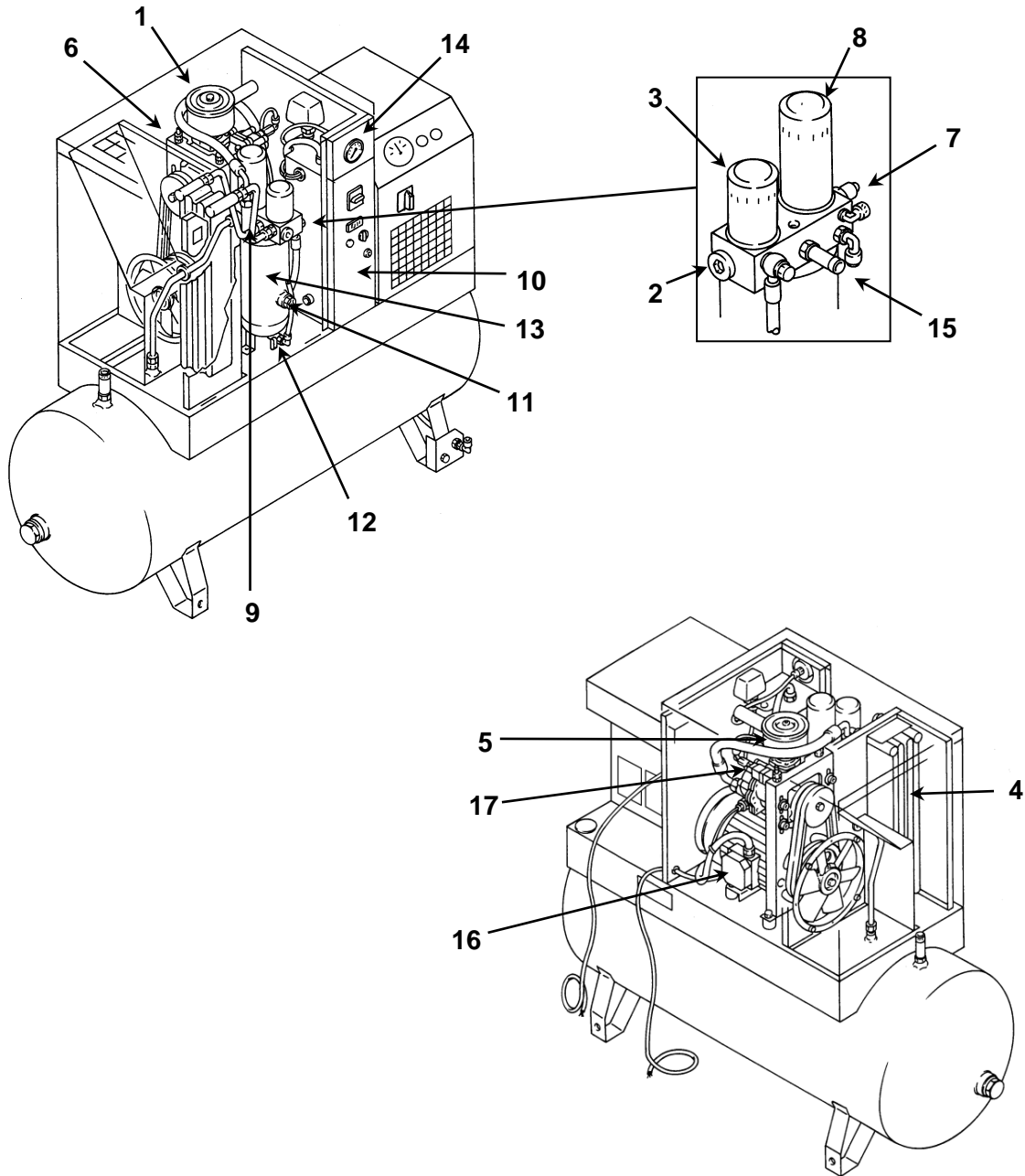

14.3 COMMAND AND CONTROL PANEL



BEFORE CARRYING OUT THE OPERATION TEST, READ CAREFULLY AND ACQUIRE A GOOD KNOWLEDGE OF THE COMMAND FUNCTIONS.

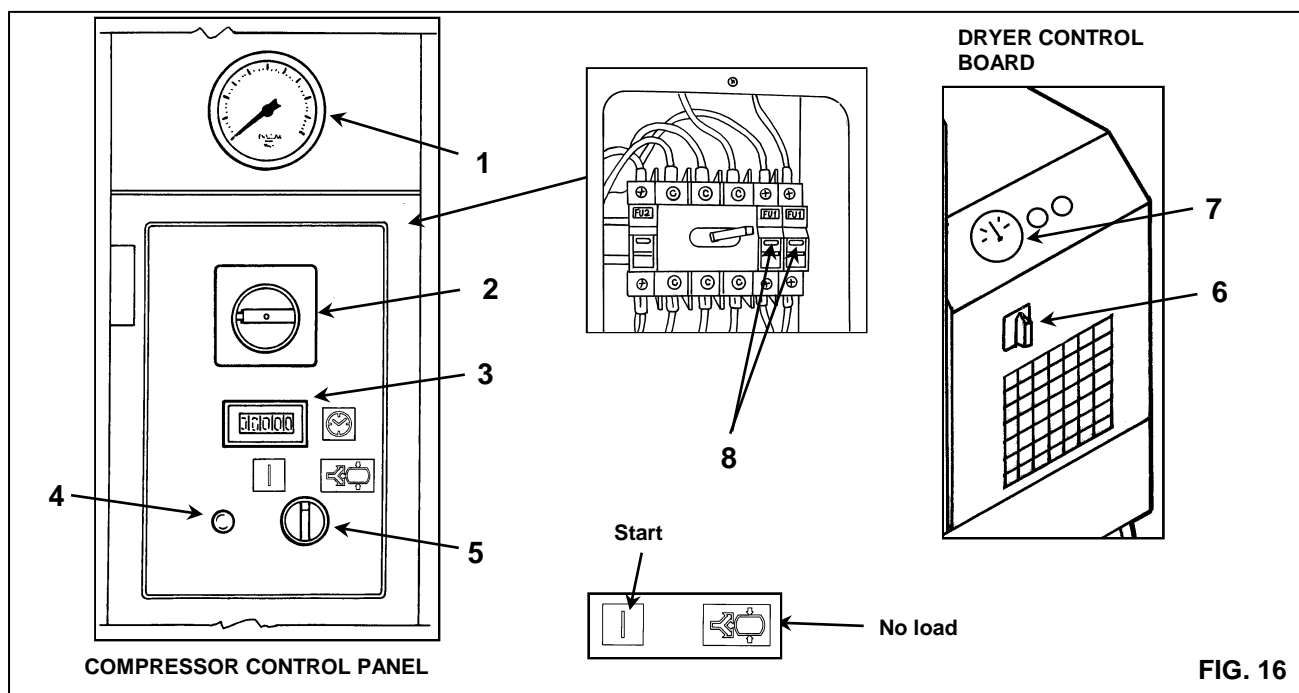

FIG. 16

- 1) Delivery pressure gauge
- 2) Isolating switch - **also used as emergency stop.**
- 3) Work hour counter: indicates the hours of operation
- 4) Operation lamp
- 5) "Start" - "No Load" selector for compressor
- 6) "STOP" - "START" button dryer
- 7) Dew point indicator
- 8) Fuses for transformer



IMPORTANT: WHEN THE SWITCH Ref. 2 and 6 IS IN POSITION "OFF" THE TERMINALS ARE STILL LIVE.

STARTING: Turn "ON" the isolating switch Ref. 2

- Move the selector Ref. 5 to position "I"; the selector will return automatically.
- The compressor starts running, operation lamp Ref. 4 lights up.

STOPPING: Move the selector Ref. 5 to position "No Load"

- Wait 30 seconds to blow OFF the pressure.
- Turn "OFF" the isolating switch Ref. 2



CAUTION: WAIT AT LEAST 30 SECONDS BEFORE STARTING THE MACHINE AFTER SWITCH OFF.

15.0 ORDINARY MAINTENANCE TO BE DONE BY THE USER



BEFORE CARRYING OUT ANY MAINTENANCE IT IS OBLIGATORY TO STOP THE MACHINE AND DISCONNECT IT FROM THE POWER MAINS AND FROM THE COMPRESSED AIR DISTRIBUTION NETWORK.

The maintenance jobs described in this chapter may be carried out by the user.
The more complex maintenance jobs which require professionally skilled personnel are listed in the chapter on **GENERAL ROUTINE MAINTENANCE. (See Chap. 21.0)**

15.1 MAINTENANCE PROGRAMME

- OPERATIONS THAT MAY BE CARRIED OUT BY THE USER
- ■ OPERATIONS THAT REQUIRE SKILLED PERSONNEL; THESE OPERATIONS ARE ILLUSTRATED IN PART "B" OF THIS MANUAL.

These maintenance intervals are recommended for work environments that are not dusty and are well ventilated. For particularly dusty environments, double the frequency of controls.

Every 24 working hours	■ Drain condensate from the air tank
Every 50 working hours	<ul style="list-style-type: none"> ■ Drain condensate from the oil tank ■ Check the oil level
Every 500 hours	<ul style="list-style-type: none"> ■ Clean the air suction filter ■ Check automatic condensation emptying ■ Clean the condenser battery (on the dryer if fitted) ■ Clean the dirt collection filter ■ ■ Check belt tension
Every 2000 hours	<ul style="list-style-type: none"> ■ Change the suction filter ■ ■ Change the oil (*) ■ ■ Change the oil filter
Every 4000 hours	<ul style="list-style-type: none"> ■ ■ Clean the finned surface of the air-oil cooler ■ ■ Change the oil separating filter

* It is recommended that the compressor oil be changed once per year, regardless of the number of hours of operation. Oil must be changed more frequently than once per year if the compressor is installed in a dirty environment.

15.2 DRAINING CONDENSATE FROM THE OIL TANK

If the compressor work cycle contemplates long pauses during which the machine cools down, a certain amount of condensate will gather in the oil tank. This happens, for example, when stopping overnight or at weekends. The condensate must be drained off every 50 hours **or every week**. This operation may be performed only when the machine is cold, that is when it has been switched off for at least 8 hours.



BEFORE DRAINING THE CONDENSATE IT IS OBLIGATORY TO STOP THE MACHINE AND DISCONNECT IT FROM THE POWER MAINS.

Proceed as follows:

- Turn in position "No load" the selector Rif. 1 Fig. 17
- Wait 30 seconds to blow OFF the pressure
- Stop the machine, turning in "OFF" position the isolating switch Ref. 2 Fig. 17.
- Press the button switch Rif. 3 Fig. 17 (on the dryer if fitted).
- Turn on the differential supply switch, Ref. 4 (on the screw-compressor) and Ref. 5 (on the dryer if fitted) Fig. 17.

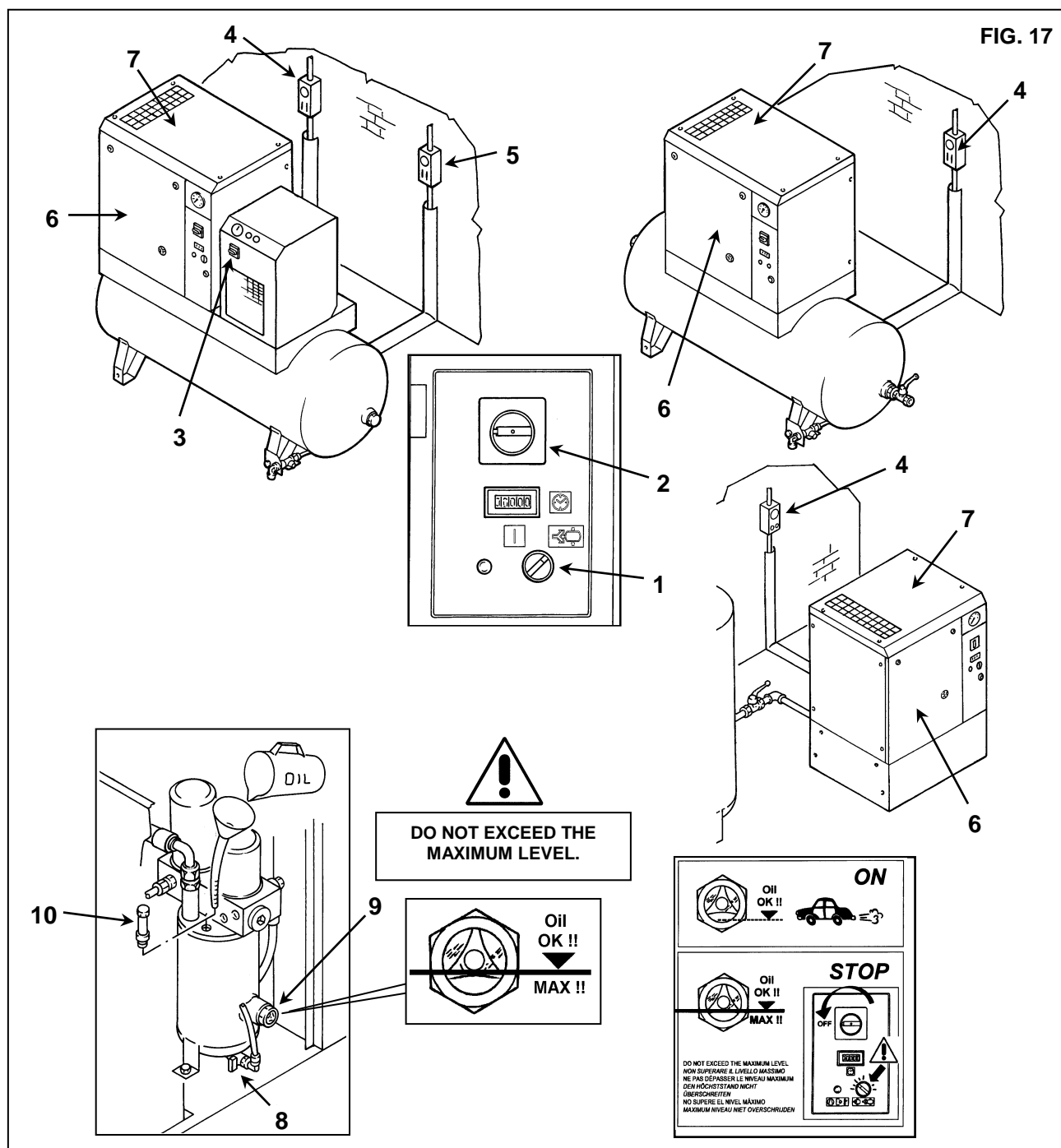

ENGLISH

- Wait for the machine to cool down.
- Remove the panel Ref. 6 Fig. 17 with the key provided.
- SLOWLY turn on the tap Ref. 8 Fig. 17 and let the condensate flow out.
- When the first traces of oil appear, turn off the tap.



CONDENSATE MUST BE DISPOSED OF IN CONFORMITY WITH THE LOCAL REGULATIONS IN FORCE.

- Check the oil level on the indicator Ref. 9 Fig. 17.
- If the oil level is under the minimum, top up as described at point **15.3**.



USE OIL OF THE SAME TYPE AS THAT ALREADY IN THE MACHINE; DO NOT MIX DIFFERENT TYPES OF OIL

15.3 CHECK OIL LEVEL AND TOP UP

- **Stop the machine, turning in “OFF” position the isolating switch Ref. 2 Fig. 17, when the selector Ref. 1 Fig. 17 light is ON**
- **WAIT A 10 MINUTES FOR THE FOAM IN THE OIL COLLECTOR TO ABATE.**
- Check the oil level on the indicator Ref. 9 Fig. 17.
- If the oil level is too low, fill up as follows: **to the red line.**
- Turn in “OFF” position the isolating switch Rif. 3 Fig. 17 (on the dryer if fitted)
- Turn on the differential supply switch, Ref. 4 (on the screw-compressor) and Ref. 5 (on the dryer if fitted) Fig. 17.



USE OIL OF THE SAME TYPE AS THAT ALREADY IN THE MACHINE; DO NOT MIX DIFFERENT TYPES OF OIL.



BEFORE CARRYING OUT ANY OPERATION ON THE MACHINE, ENSURE THAT THE ELECTRIC POWER SUPPLY HAS BEEN DISCONNECTED.

- Open the front protection Ref. 6 Fig. 17 using the special key.
- Remove the fixed protection device (machine cover) Ref. 7 Fig. 17.
- Slowly unscrew the oil cap Ref. 10 Fig 17, ensuring there is no pressure inside.
- Top up to maximum level Ref. 9 Fig. 17, with oil of the same type in the compressor.
- Close the oil manifold cap Ref. 10 Fig. 17.
- Close the fixed protection (machine cover) Ref. 7 Fig. 17 device again, using the appropriate safety screws.
- Close the front protection Ref. 6 Fig. 17.

15.4 CLEANING THE FILTERING PANEL

- Turn in position “ No load “ the selector Rif. 1 Fig. 17.
- Wait 30 seconds to blow OFF the pressure
- Stop the machine, turning in “OFF” position the isolating switch Ref. 2 Fig. 17.
- Turn on the differential supply switch Rif. 4 Fig. 17.
- Clean the filtering panel Rif. 1 Fig. 17A with a jet of air wash it with water, **do not use solvents.**

FIG. 17A

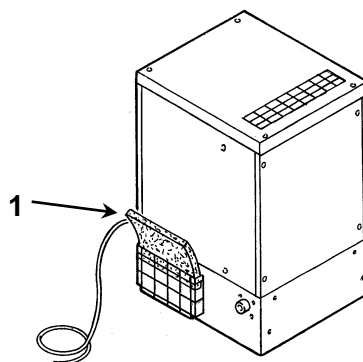

EVERY 50 WORKING HOURS, CLEAN THE FILTERING PANEL.

15.5 CLEANING THE SUCTION FILTER OR CHANGING THE FILTER

- Turn in position "No load" the selector Rif. 1 Fig. 18
- Wait 30 seconds to blow OFF the pressure.
- Stop the machine, turning in "OFF" position the isolating switch Ref. 2 Fig. 18.
- Turn in "OFF" position the isolating switch Rif. 3 Fig. 18 (on the dryer if fitted)
- Turn on the differential supply switch, Ref. 4 (on the screw-compressor) and Ref. 5 (on the dryer if fitted) Fig. 18.



HOT PARTS INSIDE

- Remove the fixed protection device (machine cover) Ref. 6 Fig. 18.
- Remove the cover Ref. 7 Fig. 18 (Check the direction of the arrow).
- Remove the filter Ref. 8 Fig. 18.

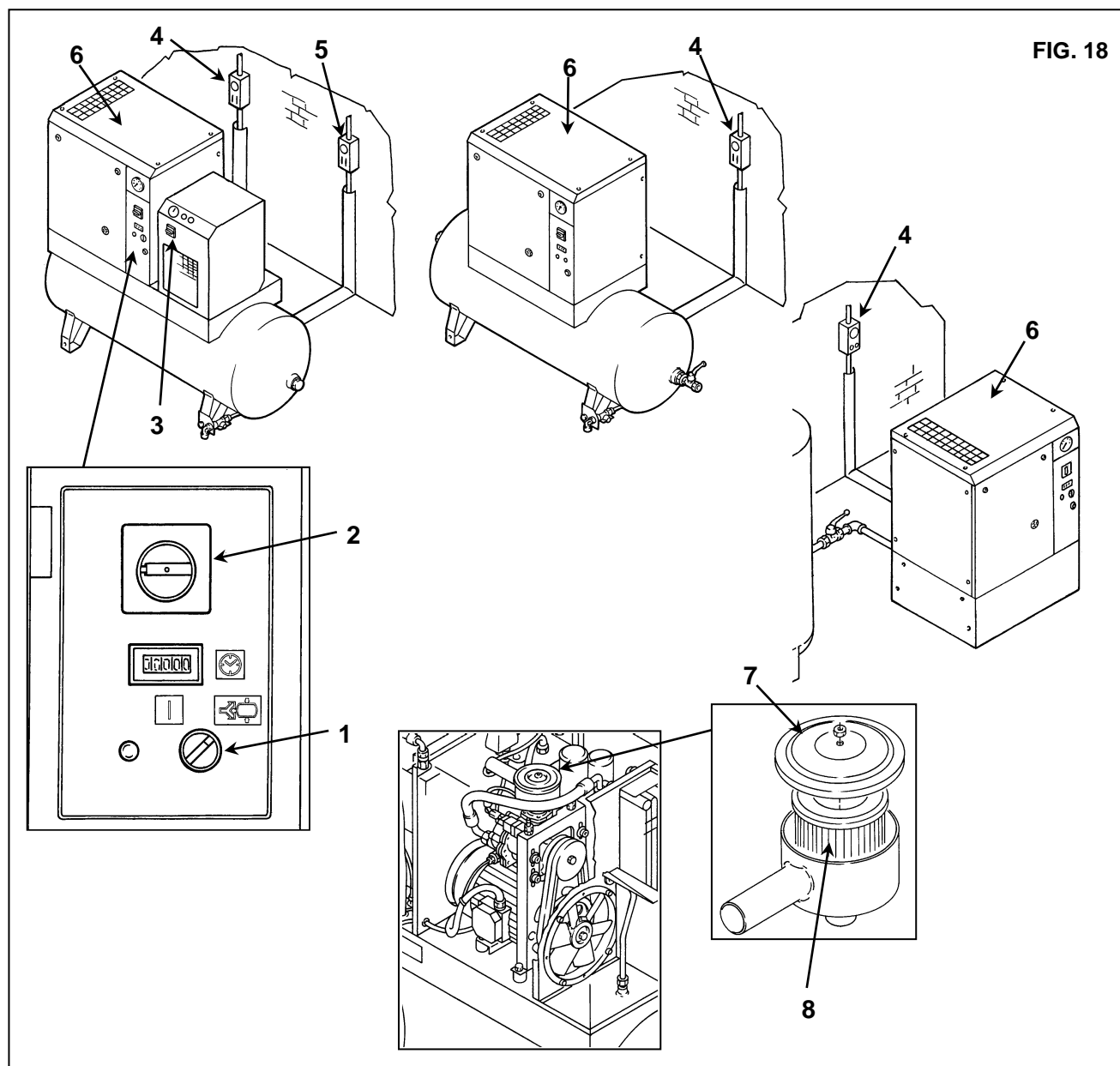

FIG. 18



AVOID DROPPING FOREIGN BODIES INTO THE SUCTION MANIFOLD.

- Clean the filter with a jet of air, working from inside to outside, **DO NOT USE WATER OR SOLVENTS**. Alternatively, fit a new filter.
- Clean the disk on which the filter rests with a clean cloth.
- Fit the filter and the cover
- If necessary, dispose of the old filter in conformity with the local regulations in force.
- Close the fixed protection (machine cover) Ref. 6 Fig. 18 device again, using the appropriate safety screws.

15.6 CHECKING THE AUTOMATIC AND MANUAL CONDENSATION EMPTYING (FOR DRYER AND TANK)



BEFORE CARRYING OUT ANY MAINTENANCE, STOP THE MACHINE AND DISCONNECT IT FROM THE POWER MAINS AND FROM THE COMPRESSED AIR DISTRIBUTION NETWORK.

The automatic and manual condensation drain must be checked (Rif. 1 every 500 hours and Ref. 2 every 24 hours) Fig. 19.

Proceed as follows:

- Press the "TEST" button, Ref. 1 Fig. 19, for a few seconds to check if the condensation is correctly emptied from the drainage pipe
- Check manual drain Ref. 2 Fig. 19) from the tank, to ensure that condensation is correctly emptied from the valve, **(PURGE EVERY DAY).**

FIG. 19

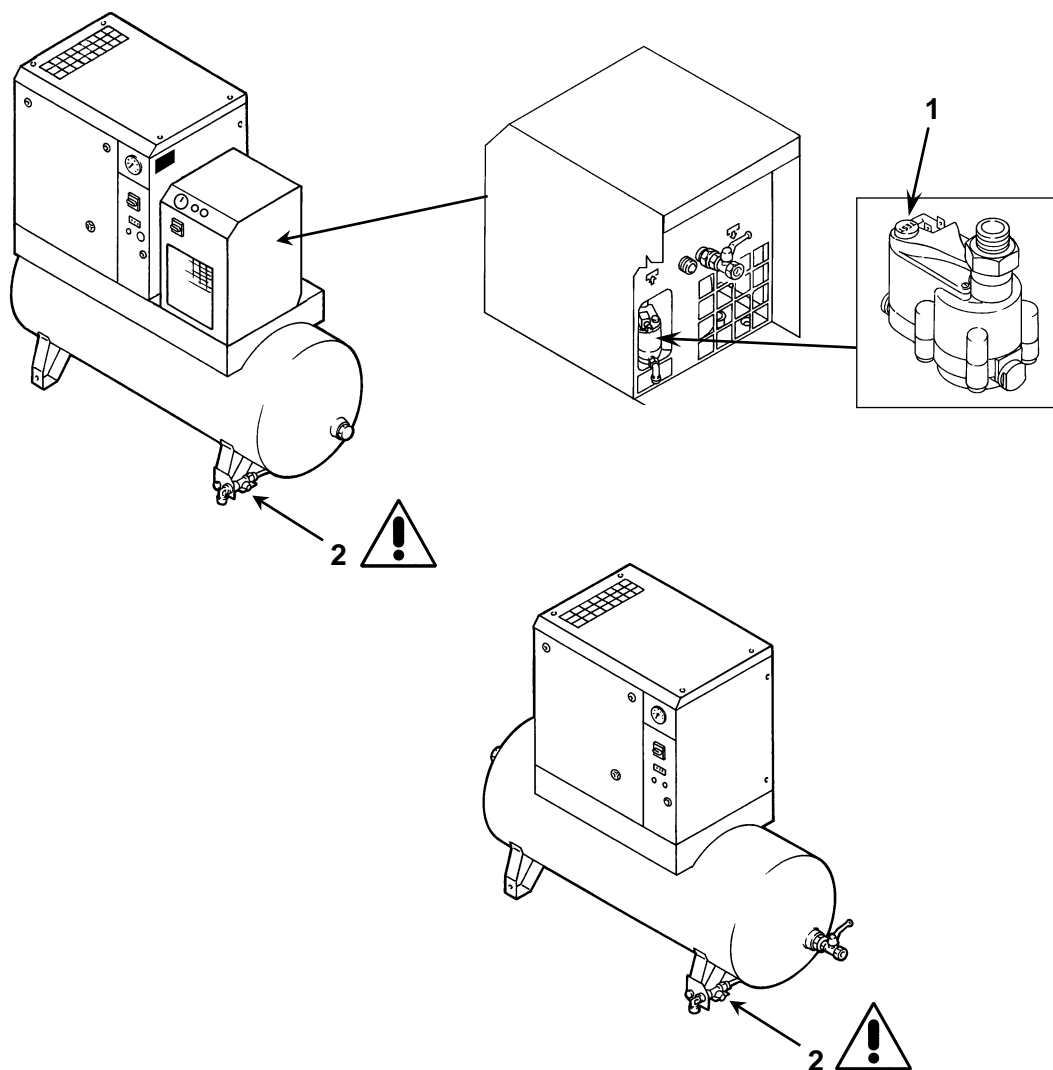

15.7 CLEANING THE CONDENSER BATTERY (FOR DRYER)



BEFORE CARRYING OUT ANY MAINTENANCE IT IS OBLIGATORY TO STOP THE MACHINE AND DISCONNECT IT FROM THE POWER MAINS AND FROM THE COMPRESSED AIR DISTRIBUTION NETWORK.

The condenser must be cleaned every month (Ref. 1 Fig. 20).

Proceed as follows:

- Turn in position " No load " the selector Rif. 2 Fig. 20
- Wait 30 seconds to blow OFF the pressure
- Stop the machine, turning in "OFF" position the isolating switch Ref. 3 Fig. 20.
- Turn in "OFF" position the isolating switch Rif. 4 Fig. 20
- Turn on the differential supply switch, Ref. 5 (on the screw-compressor) and Ref. 6 (on the dryer if fitted) Fig. 20.



HOT PARTS INSIDE

- Remove the protection Ref. 8 Fig. 20
- Clean the condenser fins Ref. 1 Fig. 20 with compressed air. **DO NOT USE WATER OR SOLVENTS.**
- Close the protection Ref. 8 Fig. 20.

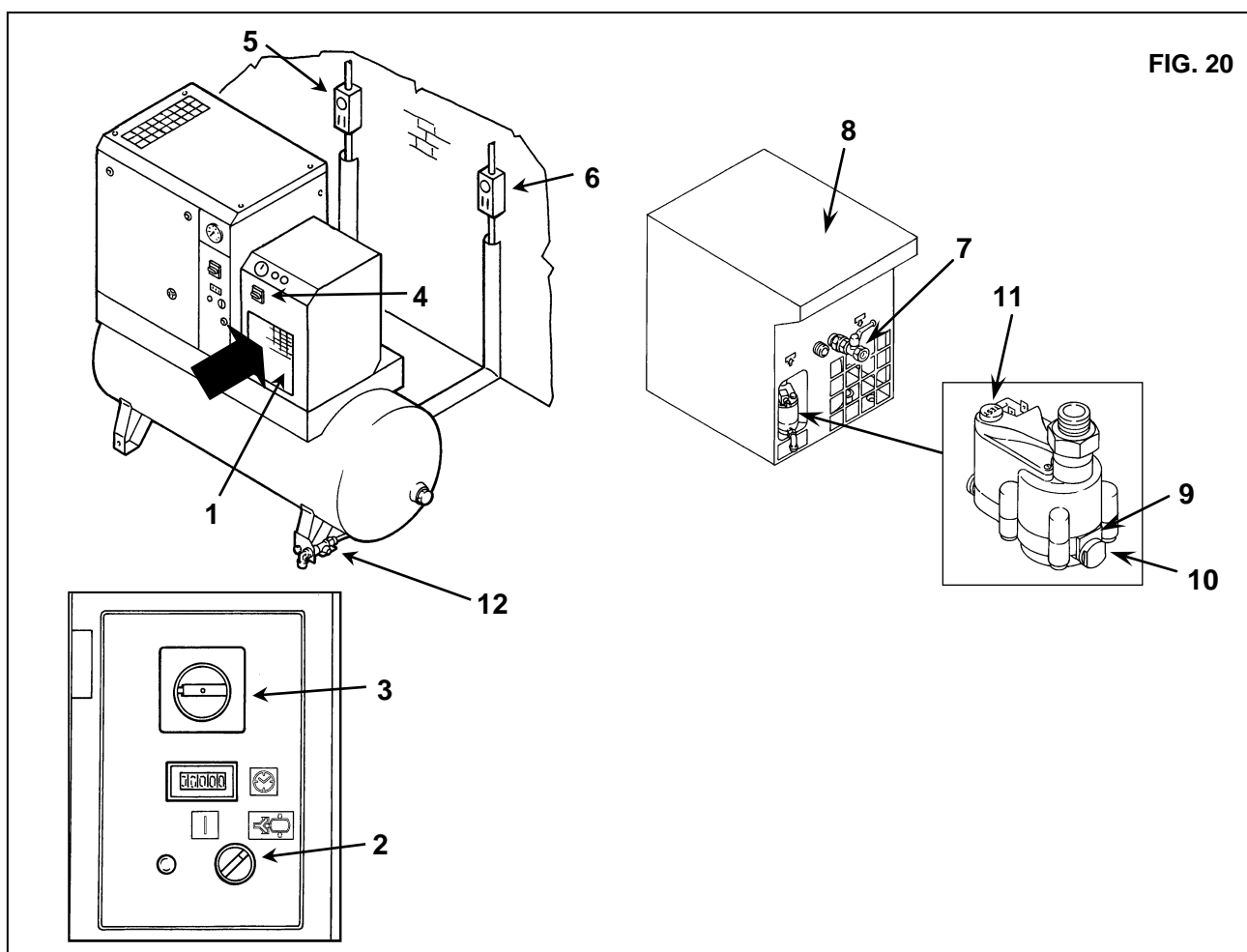

FIG. 20

15.8 CLEAN THE DIRT COLLECTION FILTER FOR DRYER (Fig. 20)



BEFORE CARRYING OUT ANY MAINTENANCE, STOP THE MACHINE AND DISCONNECT IT FROM THE POWER MAINS AND FROM THE COMPRESSED AIR DISTRIBUTION NETWORK.

Proceed as follows:

- Close the tap Ref. 7 Fig. 20
- Turn in position " No load " the selector Rif. 2 Fig. 20
- Wait 30 seconds to blow OFF the pressure
- Stop the machine, turning in "OFF" position the isolating switch Ref. 3 Fig. 20.
- Depressurise the dryer by pressing the "TEST" condensation emptying button (for about 10-20 seconds), which is fitted on the timer, Ref. 11 Fig. 20.

- Turn in "OFF" position the isolating switch Rif. 4 Fig. 20
- Turn on the differential supply switch, Ref. 5 (on the screw-compressor) and Ref. 6 (on the dryer if fitted) Fig. 20.
- Release pressure from the machine by turning on the tap Ref. 12 Fig. 20.
- Remove the stopper Ref. 10 Fig. 20
- Remove the filter Ref. 9 Fig. 20
- Clean the filter Ref. 9 Fig. 20 with a jet of air, working from inside to outside.
- Install the filter, fix the plug.

16.0 PERIODS OF INACTIVITY

If the machine has to remain inactive for a long period:

- Close the tap Ref. 1 and Ref. 2 Fig. 21.
- Depressurise the dryer by pressing the "TEST" condensation emptying button (for about 10-20 seconds), which is fitted on the timer, Ref. 11 Fig. 20.
- To turn in position "No load" the selector Rif. 4 Fig. 21
- Wait 30 seconds to blow OFF the pressure
- Stop the machine, turning in "OFF" position the isolating switch Ref. 5 Fig. 21.
- Turn in "OFF" position the isolating switch Rif. 6 Fig. 21 (on the dryer if fitted)
- Turn on the differential supply switch, Ref. 7 (on the screw-compressor) and Ref. 8 (on the dryer if fitted) Fig. 21.
- Release pressure from the machine by turning on the tap Ref. 3 Fig. 21.
- Close the taps Rif. 3 Fig. 21 off again after discharging all the residual air pressure.

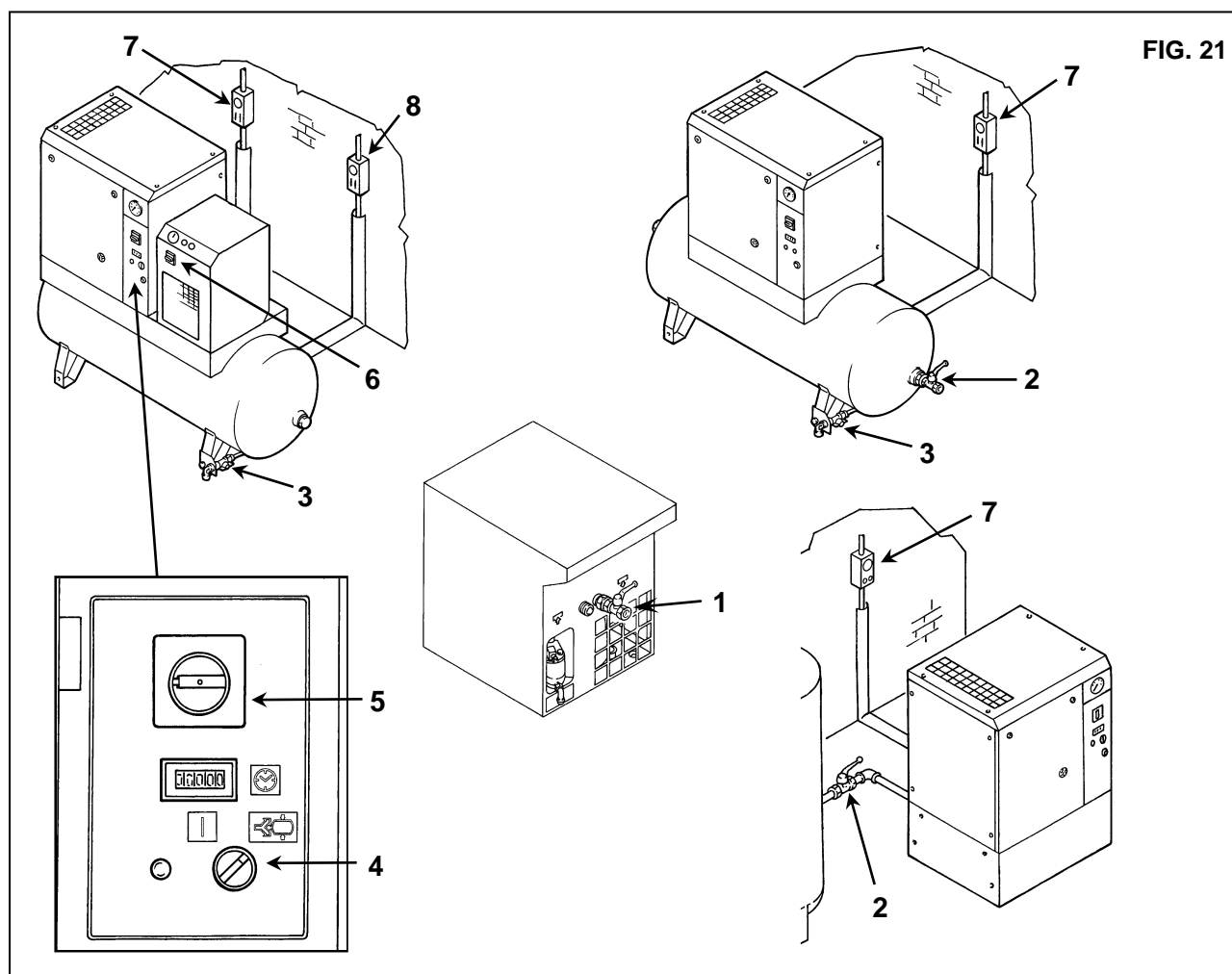

During periods of inactivity the weather must be protected against atmospheric agents, dust and humidity which could damage the motor and the electrical system.

To restart the machine after periods of inactivity, consult the manufacturer.

17.0 SCRAPPING THE UNIT

If the machine is to be scrapped, it must be dismantled into parts of the same material, to be disposed of according to the local regulations in force.



ALWAYS RESPECT THE REGULATIONS IN FORCE FOR DISPOSING OF OLD OIL AND OTHER POLLUTING MATERIALS SUCH AS SOUND-DEADENING, INSULATING FOAM, ETC.

18.0 LIST OF SPARE PARTS FOR ROUTINE MAINTENANCE

Ref.	DESCRIPTION	Code	Q.ty	HP 10 kW 7,5			HP 15 kW 11		
				6,8 bar (PSI 100)	8,6 bar (PSI 125)	10 bar (PSI 145)	6,8 bar (PSI 100)	8,6 bar (PSI 125)	10 bar (PSI 145)
1	Suction air filter (1st Serie)	2200640814	1			■			■
2	Oil filter	6211472550	1	■	■	■	■	■	■
3	Separator cartridge	6221372850	1	■	■	■	■	■	■
4	Filter-air assy. (1st Serie)	2202251236	1			■			■
5	Belt	0367010060	2		■	■			
5	Belt	0367010058	2	■					
5	Belt	0367010056	2				■	■	■
6	Suction air filter (2nd Serie) from following serial number onwards: "CAI 374630"	6211473950	1	■	■	■	■	■	■
7	Filter-air assy. (2nd Serie) from following serial number onwards: "CAI 374630"	6211473850	1	■	■	■	■	■	■

FIG. 22

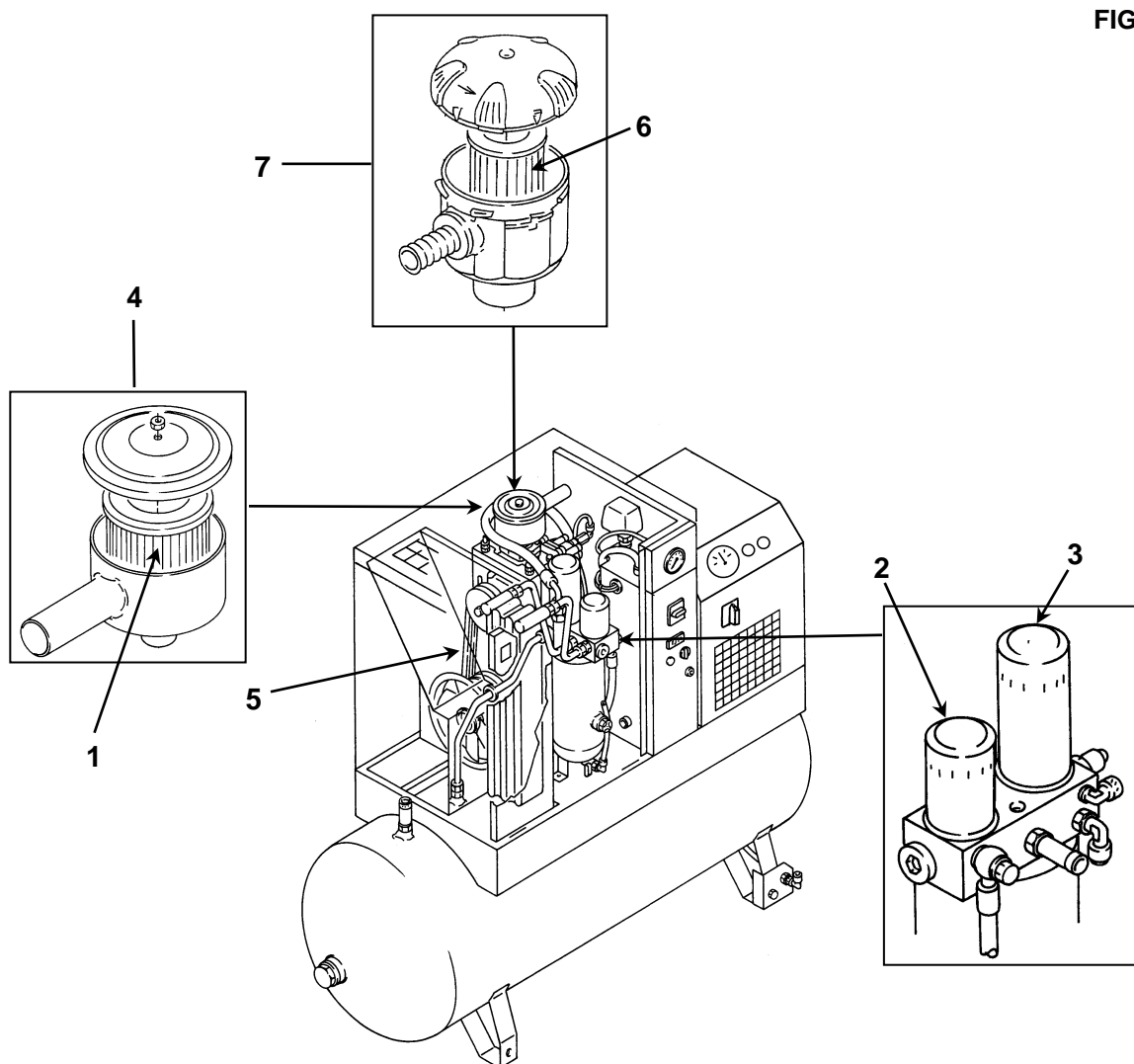

19.0 TROUBLE-SHOOTING AND EMERGENCY REPAIRS

N.B. OPERATIONS MARKED ■ ■ MUST BE CARRIED OUT BY PROFESSIONALLY SKILLED PERSONNEL APPROVED THE MANUFACTURER



ALL WORK MUST BE CARRIED OUT BY PROFESSIONALLY SKILLED PERSONNEL. BEFORE CARRYING OUT ANY MAINTENANCE STOP THE MACHINE AND DISCONNECT IT FROM THE POWER MAINS.

19.1 TROUBLE-SHOOTING AND EMERGENCY REMEDIES FOR ROTARY SCREW COMPRESSOR

FAULT FOUND	POSSIBLE CAUSES	OBSERVATIONS
1) The machine does not start	1A - no power 1B - the transformer protection fuse is broken	- check the power supply line, Chapter 12.2 - replace fuse (Ref. 8 Fig. 16)
2) The machine does not start	2A - the thermal protection in the main motor has triggered	- To rearm, the thermic relay Ref. OL wiring diagram
3) The machine does not start.	3A - the oil-overheating thermostat has triggered.	- environment temperature too high; improve ventilation in the compressor room, Chapter 9.2 ■ ■ - cooling radiator is dirty, clean the radiator - oil level too low; top up the oil tank
4) The compressor does not reach working pressure	4A - the compressed air consumption is too high 4B - the discharge electrovalve remains open, Ref. SOL wiring diagram	■ ■ - check the electric system
5) Excess oil consumption	5A - deteriorated oil separating filter 5B - oil level is too high	■ ■ - change the oil separating filter, Chapter 23

19.2 TROUBLE-SHOOTING AND EMERGENCY REPAIRS FOR THE DRYER



ALL WORK MUST BE CARRIED OUT BY PROFESSIONALLY SKILLED PERSONNEL. BEFORE CARRYING OUT ANY MAINTENANCE, STOP THE MACHINE AND DISCONNECT IT FROM THE POWER MAINS.

N.B. OPERATIONS MARKED ■ ■ MUST BE CARRIED OUT BY PROFESSIONALLY SKILLED PERSONNEL APPROVED THE MANUFACTURER

FAULT FOUND	POSSIBLE CAUSES	OBSERVATIONS
1) No compressed air passes through the dryer outlet	1A) The pipes are frozen inside	■ ■ -The bypass valve of the hot gas is broken or out-of-calibration -The room temperature is too low and the evaporators piping are obstructed with ice
2) Presence of condensate in the pipings.	2A) The condensate separator does not work correctly 2B) The dryer is working outside its rating 2C) The dryer is working under bad conditions of condensation	■ ■ -Check the solenoid exhaust valve ■ ■ -Check the drainage timer -Check the flow rate of treated air -Check the room temperature -Check the air temperature at the dryer inlet. -Clean the condenser. ■ ■ -Check the good operation of the fan.
3) The compressor head is very hot > 55 °C (> 131 °F)	Make reference to 2B Make reference to 2C 3A) The cooling circuit is not working with the right gas charge	■ ■ -Check if there are leaks of refrigerating gas. ■ ■ - Charge it again.
4) Motor cuts out on overload	Make reference to 2B Make reference to 2C Make reference to 3A	
5) The motor hums and does not start.	The line voltage is too low. You switched the machine off and on again without leaving enough time for the pressure balancing. The starting system of the motor is defective.	-Contact the electric power company -Wait a few minutes before starting the machine again. ■ ■ -Check the running and starting relays and condensers (if any)
6) The compressor is very noisy.	Troubles with the internal mechanical parts or with the valves	

PART “B”



THIS PART OF THE INSTRUCTIONS MANUAL IS RESERVED FOR CERTIFIED, FACTORY APPROVED TECHNICIANS.

20.0 STARTING UP



BEFORE PERFORMING MAINTENANCE ON THE COMPRESSOR (OR DRYER), MAKE SURE THAT BOTH UNITS HAVE BEEN DISCONNECTED FROM THE MAIN ELECTRIC POWER SUPPLY BY SWITCHING OFF THE DISCONNECT SWITCH TO BOTH UNITS.

20.1 PREPARING FOR SETTING UP

After checking everything as indicated in Chap. 12, follow the instructions in Fig. 23.

- Fit the sound-deadening panels Ref. 1
- These parts are packed in the bodywork.

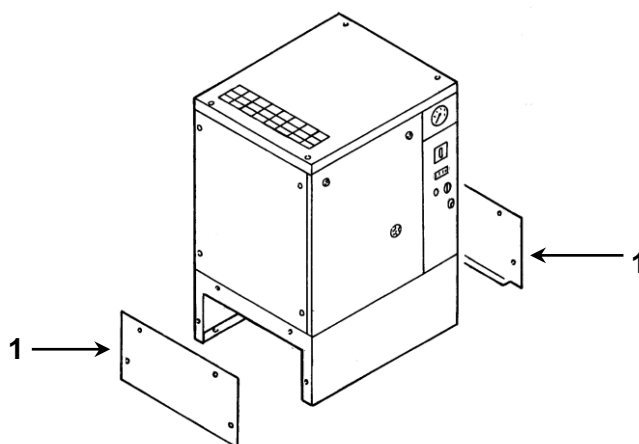

FIG. 23

20.2 PRELIMINARY CHECKS

Check the oil level Ref. 1 Fig. 23A ; when delivered the machine is filled with oil; if the oil level is not as intended, top up with the same oil as the original type.

If more than 3 months have passed between the inspection in the factory and the date of installation, lubricate the screw group before starting up, following the procedure described below:

- Remove the protection Ref. 2 Fig. 23A
- Remove the fixed protection device (machine cover) Ref. 3 Fig. 23A.
- Remove the cover Ref. 4 Fig. 23A
- Remove the air filter Ref. 5 Fig. 23A
- Pour a little oil into the suction unit.
- Reassemble the air filter Ref. 5 Fig. 23A
- Reassemble the cover Ref. 4 Fig. 23A

If more than 6 months have passed between the inspection in the factory and the date of installation, consult the manufacturer.

20.3 STARTING THE DRYER

Start the dryer before turning on the compressed air.

The compressed air piping will be free of condensate only by doing so.

The dryer must be kept running during all the time the air compressor is running. **WARNING: if the dryer is switched off, before starting it again, wait at least 5 minutes in order to allow the pressure balancing.**

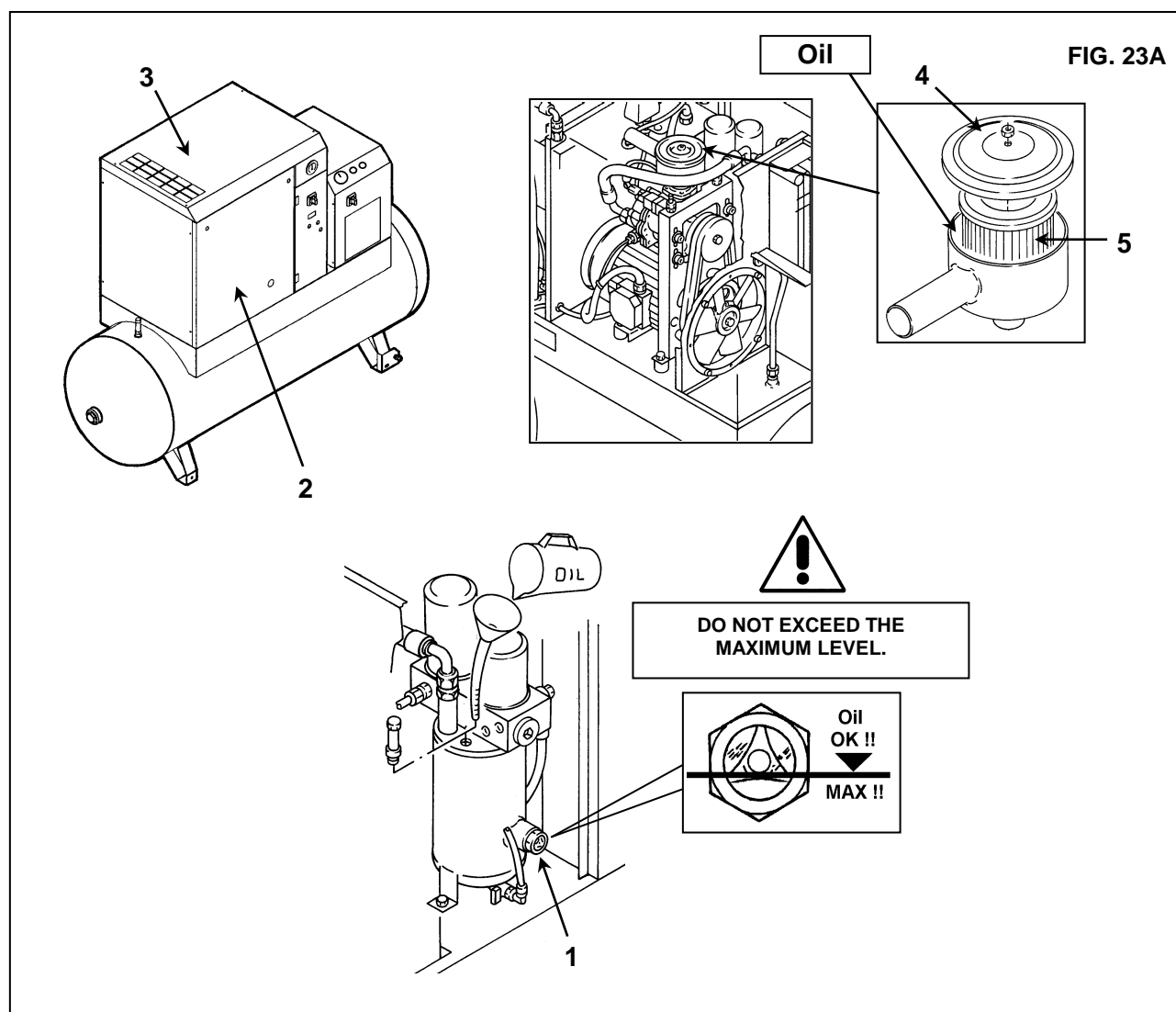

20.4 CHECK THE COMPRESSOR ROTATION DIRECTION AND START UP

- Check that all the protective shields are in place.
- Apply voltage to the control panel by operating the automatic differential switch of the line Ref. 1 Fig. 24.
- Start the compressor by turning the switch to ON, Ref. 2 Fig. 24 and after 1 second, stop it by turning the switch to OFF.
- If the rotation is correct, the paper sheet Ref. 3 is blown up (See Fig. A)
- If the rotation is not correct, the paper sheet remains flat (See Fig. B) **PHASE INCORRECT**



ALL WORK ON THE ELECTRIC PLANT, HOWEVER SLIGHT, MUST BE CARRIED OUT BY PROFESSIONALLY SKILLED PERSONNEL.

- Disconnect the energy supply and invert two connections as per Ref. 1 Fig. B.

IT IS ADVISABLE NOT TO DO ANYTHING ON THE MACHINE PANEL.

IF ALL THE INSTRUCTIONS FOUND IN THIS MANUAL HAVE BEEN OBSERVED THE MACHINE CAN BE STARTED.

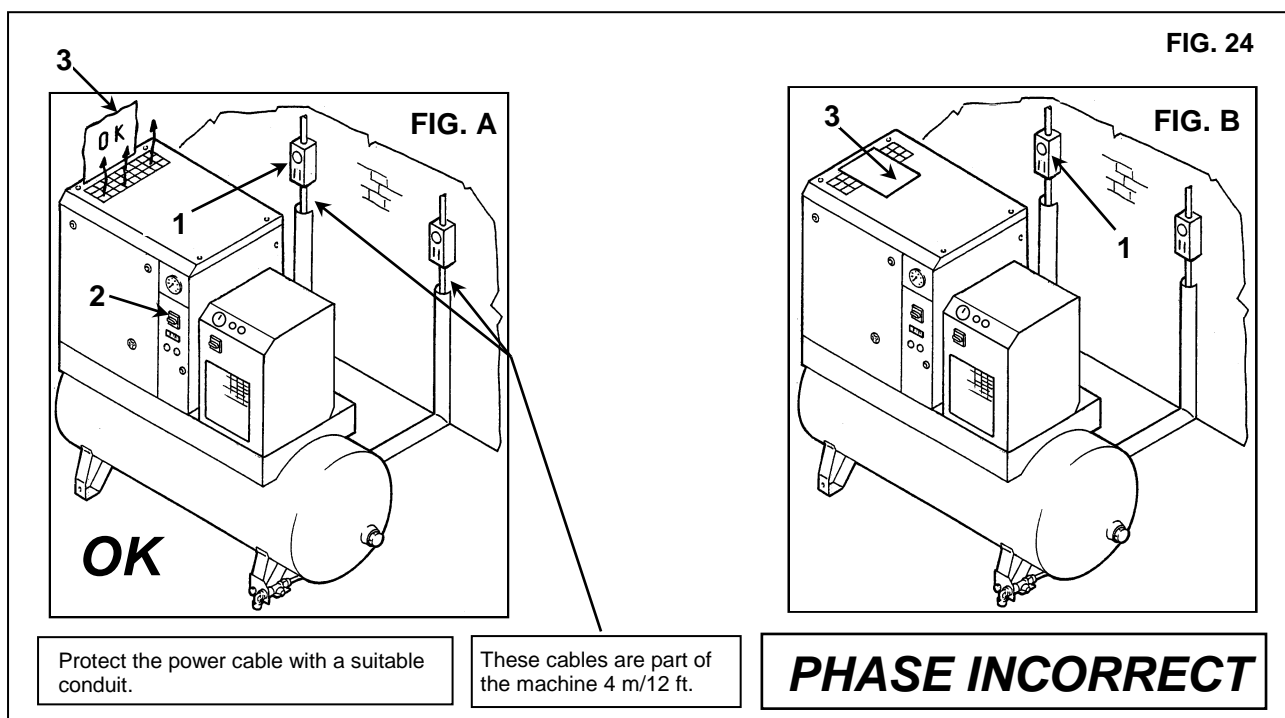
**WARNING**

- TO PREVENT WRONG ROTATION DIRECTION, THIS UNIT IS EQUIPPED WITH A PHASE SEQUENCE CONTROLLER.
- IF THE UNIT DOESN'T START-UP, PLEASE REVERSE TWO PHASES, ACCORDING TO THE USER MANUAL INDICATION.



ALL WORK ON THE ELECTRIC PLANT, HOWEVER SLIGHT, MUST BE CARRIED OUT BY PROFESSIONALLY SKILLED PERSONNEL

21.0 MAINTENANCE REQUIRES COMPLETE KNOWLEDGE AND UNDERSTANDING OF COMPRESSOR OPERATION AND MAINTENANCE



BEFORE PERFORMING ANY MAINTENANCE PROCEDURES, IT IS NECESSARY TO STOP BOTH THE COMPRESSOR AND DRYER, AND DISCONNECT BOTH UNITS FROM THE MAIN POWER SUPPLY AND CLOSE THE AIR VALVE TO THE AIR SYSTEM.

MAINTENANCE SCHEDULE

These maintenance intervals are recommended for work environments that are not dusty and are well ventilated. For particularly dusty environments, double the frequency of controls.

Every 24 working hours	<ul style="list-style-type: none"> ■ Drain condensate from the air tank
Every 50 working hours	<ul style="list-style-type: none"> ■ Drain condensate from the oil tank ■ Check the oil level
Every 500 hours	<ul style="list-style-type: none"> ■ Clean the air suction filter ■ Check automatic condensation emptying ■ Clean the condenser battery (on the dryer if fitted) ■ Clean the dirt collection filter ■ Check belt tension
Every 2000 hours	<ul style="list-style-type: none"> ■ Change the suction filter ■ Change the oil (*) ■ Change the oil filter
Every 4000 hours	<ul style="list-style-type: none"> ■ Clean the finned surface of the air-oil cooler ■ Change the oil separating filter

* It is recommended that the compressor oil be changed once per year regardless of the number of hours of operation. Oil must be changed more frequently than once per year if the compressor is operating in a dirty environment.

N.B.: THE OPERATIONS MARKED ■ ARE DESCRIBED IN PART "A" OF THIS MANUAL ON CHAPTER 15.1

22.0 CHANGING THE OIL

CAUTION: THIS OPERATION MUST BE DONE TOGETHER WITH THE OIL FILTER AND AIR FILTER EXCHANGE



BEFORE CARRYING OUT ANY MAINTENANCE JOBS IT IS OBLIGATORY TO STOP THE MACHINE AND DISCONNECT IT FROM THE POWER MAINS AND FROM THE COMPRESSED AIR DISTRIBUTION NETWORK.

Oil changing is an important operation for the compressor:

If the lubrication of the bearing is not efficient, the compressor life will be short.

The oil must be changed when the machine is still warm, that is immediately after stopping it.

The suggestions listed below should be scrupulously followed.

After draining the old oil out of the machine Ref. 1 Fig. 25.

- Fill the oil manifold Ref. 2 Fig. 25 up to the level mark

- Close all the protections (cover and front protection)

- Start the compressor.

- After about 1 minute, stop the machine, turning in "OFF" position the isolating switch Ref. 3 Fig. 25.

PROCEED AS DESCRIBED AT CHAPTER 15.3

FIG. 25

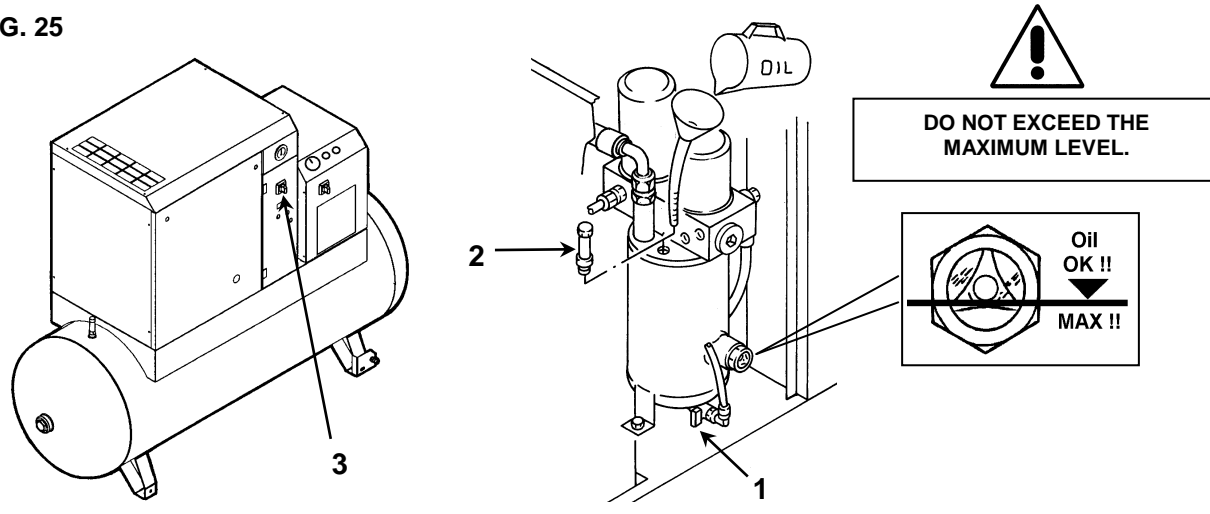

THE OLD OIL MUST BE DISPOSED OF IN COMPLIANCE WITH THE LOCAL REGULATIONS IN FORCE.

DO NOT MIX DIFFERENT OILS FROM DIFFERENT MANUFACTURERS AND DIFFERENT VICOSITIES (GRADES)

NOTE ON LUBRICANTS

When delivered the machine is filled with oil.

In normal conditions of use, these lubricants have proved to be able to withstand use for as many as 4.000 hours. However, due to the external polluting agents that get into the compressor with the air that it takes in, it is advisable to change the oil at more frequent intervals, as indicated on the routine maintenance chart.

If the compressor is being used at high temperatures (continuous operation above 90 °C – 194 °F) or in particularly severe conditions, we advise changing the oil at shorter intervals than those recommended in the maintenance chart.

23.0 REPLACING THE AIR/OIL SEPARATOR FILTER AND THE OIL FILTER



BEFORE PERFORMING ANY MAINTENANCE PROCEDURES, THE COMPRESSOR AND DRYER MUST BE STOPPED, ALL ELECTRICAL POWER DISCONNECTED USING THE MAIN POWER SUPPLY DISCONNECT SWITCHES AND THE AIR VALVE CLOSED OFF FROM THE COMPRESSED AIR SYSTEM. CHECK THAT THE COMPRESSOR IS NOT UNDER INTERNAL PRESSURE.

Proceed as follows:

- Open the front panel Ref. 1 Fig. 26 with the special key.
- Remove the fixed protection device (machine cover) Ref. 2 Fig. 26.
- Remove the oil separation filter Ref. 3 and oil filter Ref. 4 Fig. 26
- Lubricate the filter seals with a little oil before fitting.
- Tightening must be done by hand.
- Close the fixed protection (machine cover) Ref. 2 Fig. 26 device again, using the appropriate safety screws.
- Close the panel Ref. 1 Fig. 26.

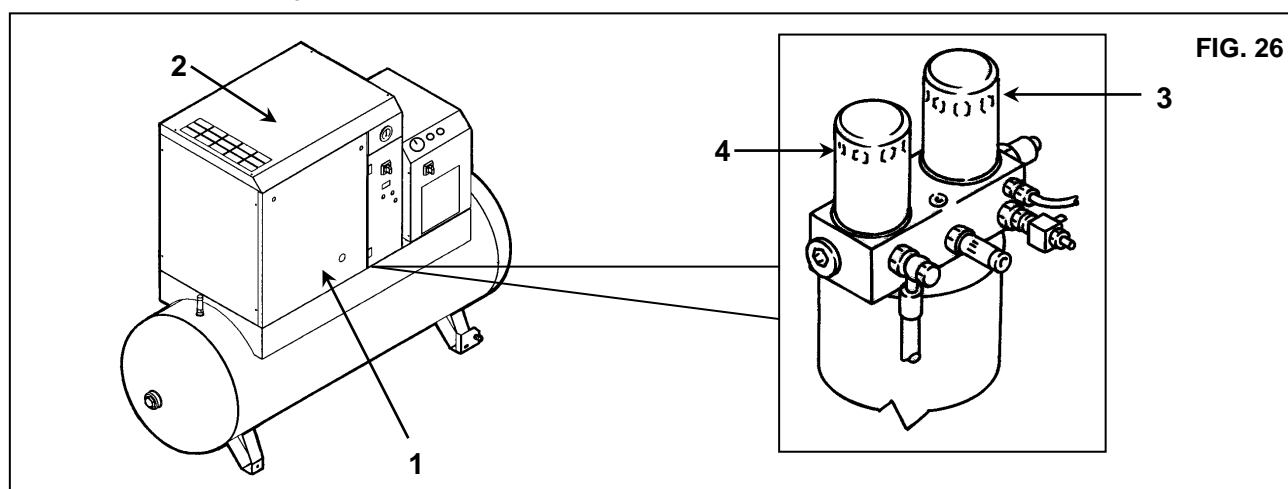

24.0 BELT TENSION



BEFORE CARRYING OUT ANY MAINTENANCE THE MACHINE MUST BE STOPPED, CUT OFF THE MACHINE FROM THE ELECTRICAL MAINS AND FROM THE COMPRESSED AIR DISTRIBUTION CIRCUIT, CHECK THAT THE MACHINE IS NOT UNDER PRESSURE.

Tightening or retightening new belts

Proceed as follows:

- Open the front panel Ref. 1 Fig. 27 with the special key.
- Remove the fixed protections device Ref. 2, 3, 4 Fig. 27.
- Slacken the screws by half a turn Ref. 5 Fig. 27
- Adjust the belt tension by turning the screw Ref. 6 Fig. 27.
- Close the screws again Ref. 5 (***) Fig. 27
- Tension is correct if, when a force of **5 kg.** Is exercised halfway along the belt between the pulleys, there is an offset of about **6 mm. / 0,2 in.** (see Fig. A).
- Close the fixed protections Ref. 2, 3, 4 Fig. 27 device again, using the appropriate safety screws
- Close the panel Ref. 1 Fig. 27.

25.0 REPLACING THE BELT



BEFORE CARRYING OUT ANY MAINTENANCE THE MACHINE MUST BE STOPPED, CUT OFF THE MACHINE FROM THE ELECTRICAL MAINS AND FROM THE COMPRESSED AIR DISTRIBUTION CIRCUIT, CHECK THAT THE MACHINE IS NOT UNDER PRESSURE.

Proceed as follows:

- Open the front panel Ref. 1 Fig. 27 with the special key.
- Remove the fixed protections device Ref. 2, 3, Fig. 27.
- Slacken the screws by half a turn Ref. 1 Fig. 28

- Release belt tension by unscrewing the screw Ref. 2 Fig. 28
- Unscrew screws Ref. 3 Fig. 28, remove the fan cowl Ref. 4
- Dismantle and remove the belt Ref. 5 (Q.ty 2) from the fan opening, and fit the new belt following the instructions in reverse order.
- **To set belt tension, proceed as given in Chap. 24.0**
- Reassemble the fan cowl Ref. 4 Fig. 28
- Reassemble the permanent protections Ref. 2, 3 Fig. 27 fixing them in place with the special safety screws
- Close the panel Ref. 1 Fig. 27

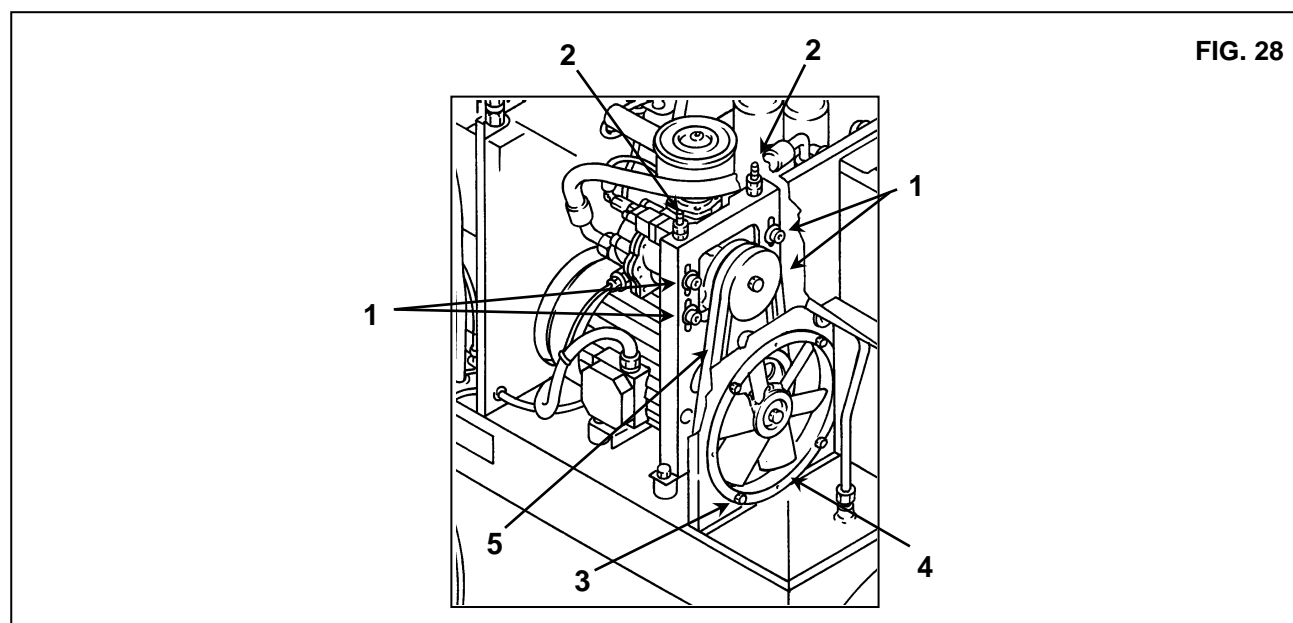
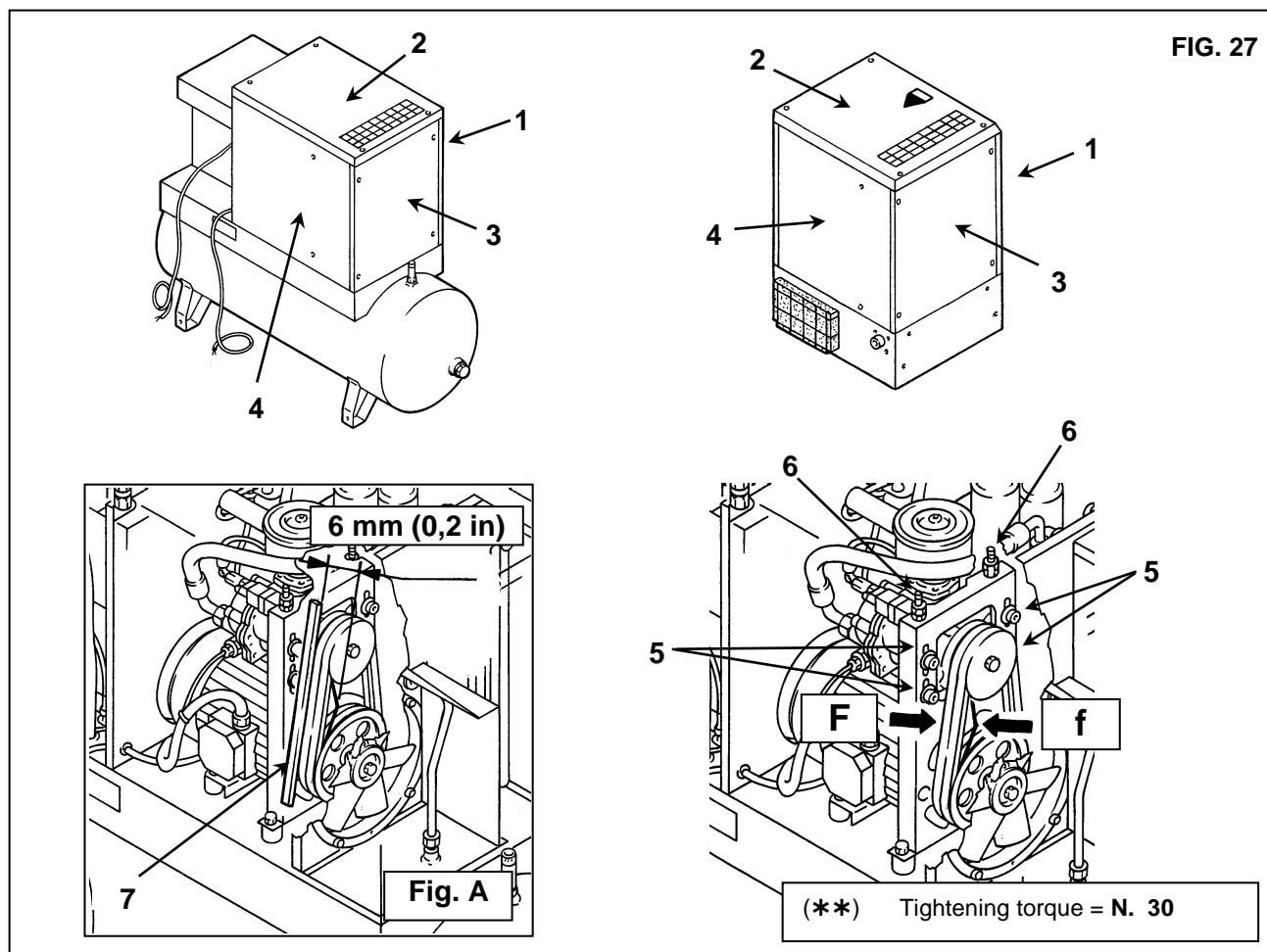

- 1 - F = 5 kg. - (11 lb.), force to be applied at the centre line, at right angles to the new belt.
 2 - f = 6 mm. - (0,2 in.), clearance after the application of F. (after 100 h operation F = 3 kg. - 6,6 lb.)

26.0 ELECTROPNEUMATIC DIAGRAM

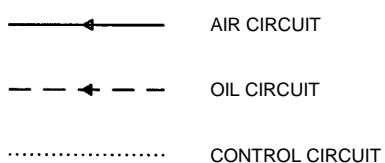
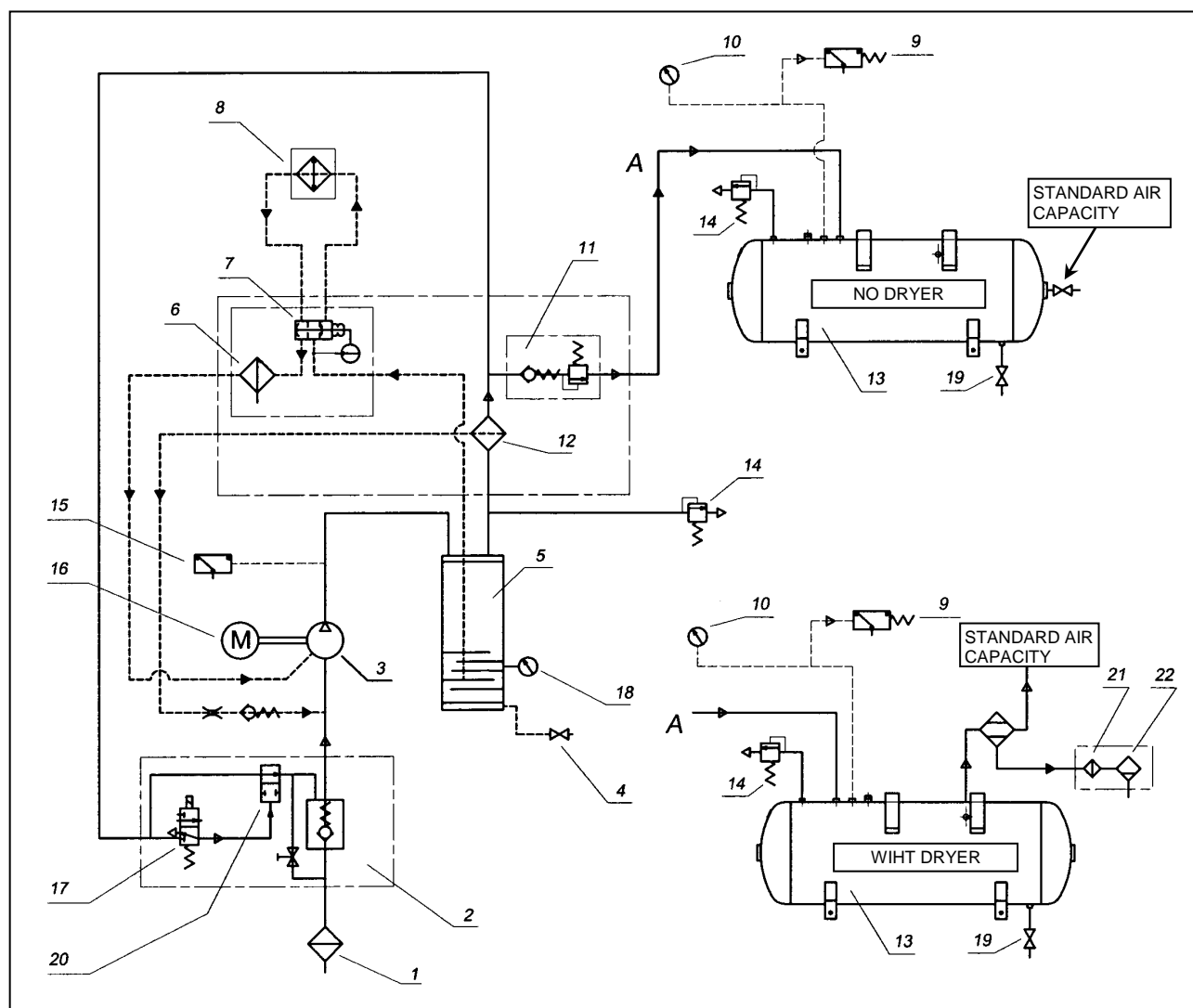

- | | |
|---------------------------|--------------------------------------|
| 1 SUCTION FILTER | 13 AIR RECEIVER |
| 2 SUCTION REGULATOR | 14 SAFETY VALVE |
| 3 SCREW COMPRESSOR | 15 SAFETY OIL TEMPERATURE |
| 4 OIL DISCHARGE VALVE | 16 ELECTRIC MOTOR |
| 5 OIL MANIFOLD | 17 NO-LOAD RUNNING SOLENOID VALVE |
| 6 OIL FILTER | 18 OIL LEVEL |
| 7 THERMOSTATIC VALVE | 19 CONDENSATE DISCHARGE VALVE |
| 8 AIR-OIL COOLER | 20 BLEED SOLENOID VALVE |
| 9 AIR PRESSURE SWITCH | 21 IMPURITY TRAP |
| 10 AIR PRESSURE GAUGE | 22 CONDENSATE ELECTRONIC DRAIN VALVE |
| 11 MINIMUM PRESSURE VALVE | |
| 12 AIR-OIL SEPARATOR | |

27.0 DRYER CALIBRACION

HOT GAS BYPASS VALVE

N.B. these valves have already been calibrated and they do not require any adjustment. A dew point different from the rated one generally depends on causes which are not attributable to their operation.

- 1) Protective cover
- 2) Adjusting screw

WORKING PRESSURES AND TEMPERATURES OF R134a

SUCTION SIDE OF REFRIGERATION COMPRESSOR		
	Evaporat. Temperat. °C (°F)	Evaporating Pressure bar (psi)
RATED VALUES (Temperat. 20 °C – 68 °F)	1 ÷ 2 (33,8 ÷ 35,6)	R134A 2,1 ÷ 2,3 (30,4 ÷ 33,3)

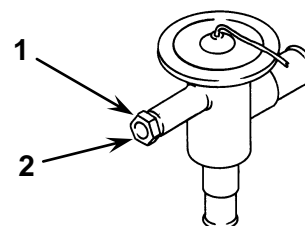

27.1 FLOW DIAGRAM OF THE DRYER

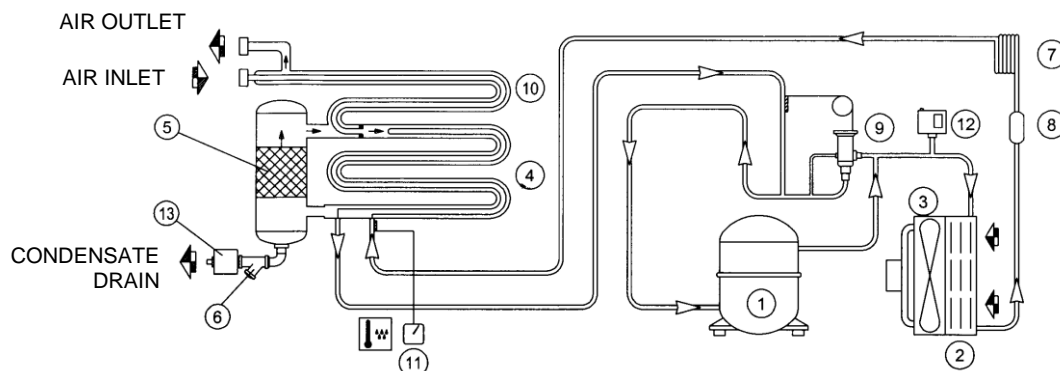

- | | |
|---------------------------------|--|
| 1 REFRIGERANT COMPRESSOR | 9 HOT GAS BYPASS VALVE |
| 2 FREON CONDENSER | 10 AIR-TO-AIR EXCANGER |
| 3 MOTOR FAN | 11 DEW POINT THERMOMETER |
| 4 EVAPORATOR | 12 FAN PRESSURE SWITCH |
| 5 DEMISTER CONDENSATE SEPARATOR | 13 CONDENSATE DISCHARGE SOLENOID VALVE |
| 6 IMPURITY TRAP | |
| 7 EXPANSION CAPILLARY TUBE | |
| 8 REFRIGERATION FLUID FILTER | |

28.0 VOLTAGE CONVERSION

IMPORTANT: Be sure to remove electrical power to the unit before performing this voltage conversion.

The standard voltage configuration for the compressor is mentioned on the data plate of the machine. To convert the operating voltage of the compressor for either 200V or 230V or 460V operation, the following simple modifications must be performed.

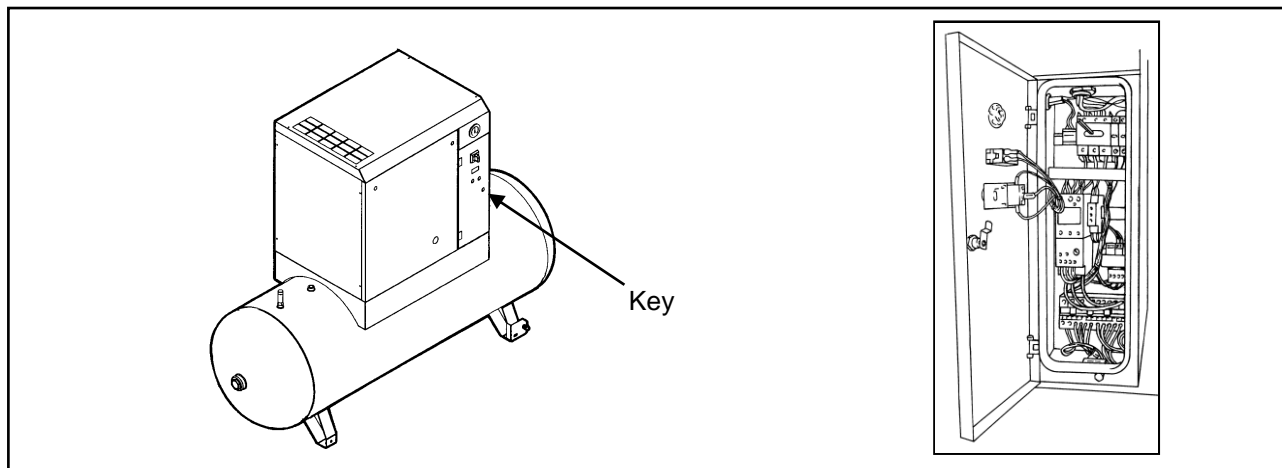

Required Modifications:

1. Adjust the motor overload (OL) setting.
2. Rewire the control power transformer (T).
3. Replace the control power fuses (FU1) with the KTK-1 / KTK 1/2 fuses provided.
4. Modify the terminal bridge configuration for the desired voltage.
5. Replace the "VOLTAGE" sticker with the appropriate voltage sticker provided.

To adjust the motor overload (OL) setting, simply rotate the adjustment screw on the face of the overload to the required setting (see table below).

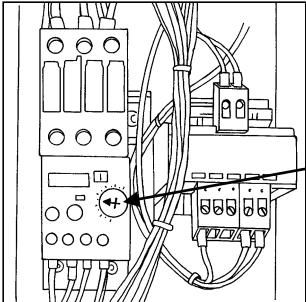

Overload (OL) Settings	10 HP 7,5 kW	15 HP 11 kW
200-208V	36.3	48
230V	34.4	45
460V	16.9	22.5

To rewire the control power transformer (T), remove the wire connected to the transformer terminal marked "460" and move the wire to the terminal marked with the desired voltage (200V or 230V).

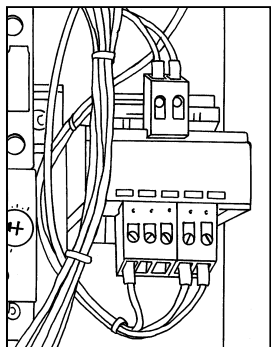

Ø 24	
Ø 200	230 460 ±
Transformer T	

Ø 24	
Ø 200	230 460 ±
Transformer T	

Ø 24	
Ø 200	230 460 ±
Transformer T	

ENGLISH

The two fuses marked FU1 are easily replaced by opening the fuseholder and replacing the fuses with the KTK-1 fuses supplied with the compressor.

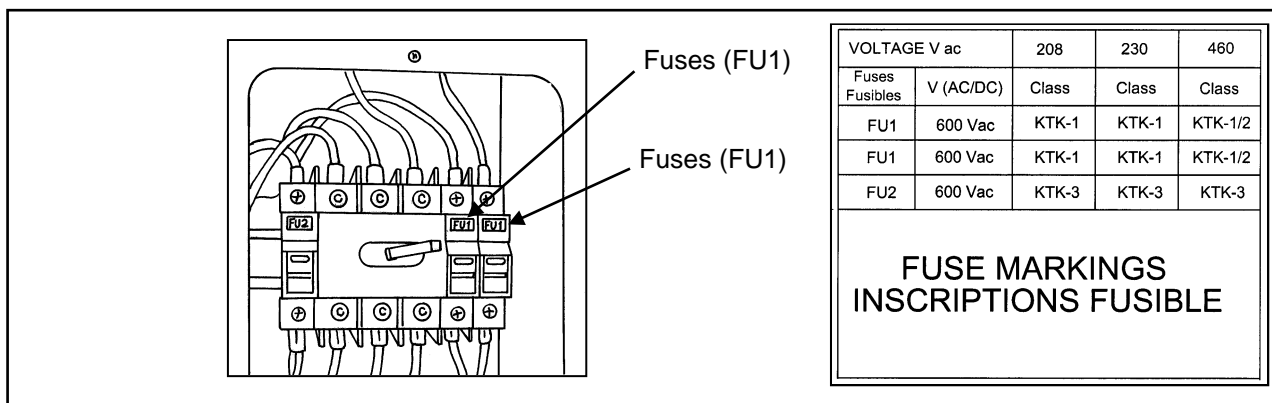

To modify the terminal bridge configuration to the motor, configure the terminal bridges for the desired voltage (200V or 460V or 230V) according to the schematic below. The terminal bridges can be easily removed using a pair of pliers. Additional terminal bridges are provided with the compressor.

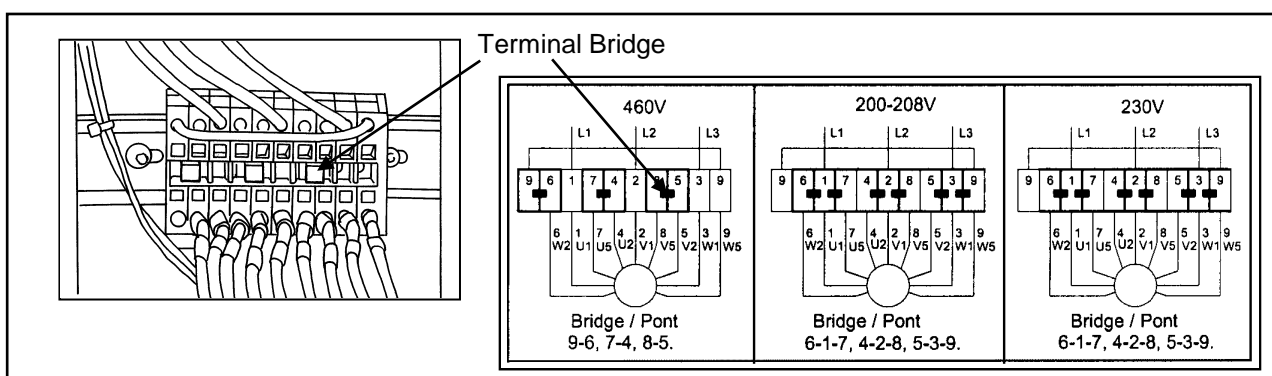

Locate the yellow voltage stickers provided with the compressor. Replace the existing sticker with the appropriate voltage sticker (200V or 230V or 460V).

